





INDEX

- 03 PRODUCTION ARBOR
- 04 SIMPLIST SERIES: SIMPLY WOOD
- 06 FLAT SERIES: WOOD-ALUMINUM
- 07 MINIMA SERIES: WOOD-ALUMINUM
- 08 ANTIQUE SURFACE
- 09 ELEGANT LINES
- 11 WINDOW MODELS
- 12 STANDART WINDOWS
- 13 STUDIO WINDOWS
- 14 PATIO DOORS
- 15 PIVOT WINDOWS/ARCHED WINDOWS
- 16 SLIDERS
- 17 SHUTTERS
- 18 SASH WINDOWS
- 19 TILT AND SLIDE SASH WINDOWS
- 20 ACCESSORIES
- 21 AUXILIARY WOODEN ELEMENTS
- 22 ENTRANCE DOORS
- 29 INTERIOR DOORS
- 36 IRON MONGERY
- 37 SUSTAINABLY SOURCED WOOD...
- 38 STAIN COLOURS
- 40 CERTIFICATES OF ARBOR
- 41 CERTIFICATES OF OUR MATERIALS
- 42 HESITATIONS ABOUT WOOD



Our production facilities are located near Istanbul, on an area, 10000 m² of which is dedicated to production, and 13000 m² to wood lot.

Our industrial capacities allow the production of most sophisticated doors and windows up to the specific designs that reflect your own style.

Use of “natural architectural elements” in our homes, where we spend an important part of our lives, carries a special importance when considered from the points of view of family and individual health. By using up-to-date production technology and the new generation natural raw materials, Fenex aims at spreading its state-of-the-art windows and doors throughout the whole world.



PRODUCTION

Each level of production has been highly automated at Fenex. All processes, from profiling to joining, painting and assembly of glass and accessories, are made by standardized and mechanized means. These processes, performed by German and Italian machinery, are controlled and supervised by an online computerized management system. The temperature and humidity in factory area are kept under strict automatic control. In this way, all of the processes are performed in standard ways until the finished product is reached, which means minimization of human mistakes.

SIMPLISTSERIES

SIMPLY WOOD

SIMPLIST windows are of complete wood, laminated in three plies.

They are produced in 3 different thicknesses, 68, 78 and 90 mm with different performances.

Air, water and wind resistance: Air class 4 / Water class 9A / Wind class C3.



68s

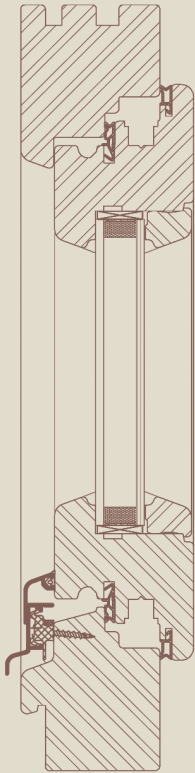

68 mm

| 68s Uw VALUE TABLE | | |
|---------------------------|-------|-------|
| Uf = | 1.40 | |
| ϵ_n / ψ_g = | 0,029 | 0,081 |
| 1.0 | 1,20 | 1,33 |
| 1.1 | 1,27 | 1,40 |
| 1.3 | 1,41 | 1,54 |
| 2.6 | 2,28 | 2,41 |
| 2.7 | 2,35 | 2,48 |
| Max glazing= | 28 mm | |

78s

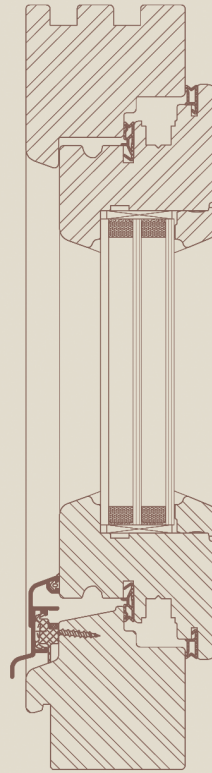

78 mm

| 78s Uw VALUE TABLE | | |
|---------------------------|-------|-------|
| Uf = | 1.28 | |
| ϵ_n / ψ_g = | 0,027 | 0,086 |
| 0.6 | 0,89 | 1,04 |
| 0.7 | 0,96 | 1,10 |
| ϵ_n / ψ_g = | 0,029 | 0,081 |
| 1.0 | 1,16 | 1,29 |
| 1.1 | 1,23 | 1,36 |
| 1.3 | 1,37 | 1,50 |
| 2.6 | 2,24 | 2,37 |
| 2.7 | 2,31 | 2,44 |
| Max glazing= | 40 mm | |

90s

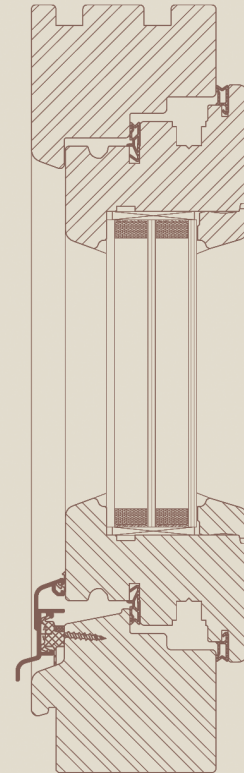

90 mm

| 90s Uw VALUE TABLE | | |
|---------------------------|-------|-------|
| Uf = | 1.15 | |
| ϵ_n / ψ_g = | 0,027 | 0,086 |
| 0.6 | 0,85 | 1,00 |
| 0.7 | 0,91 | 1,06 |
| ϵ_n / ψ_g = | 0,029 | 0,081 |
| 1.0 | 1,12 | 1,25 |
| 1.1 | 1,19 | 1,32 |
| 1.3 | 1,32 | 1,45 |
| 2.6 | 2,20 | 2,33 |
| 2.7 | 2,27 | 2,40 |
| Max glazing= | 52 mm | |

The thermal and acoustic insulation values of Fenex products have been tested and reported by ift Rosenheim Institute in Germany.

High thermal and acoustic insulation values are reached by 78s thanks to its improved design and the triple insulation glasses that can be used with acoustic laminates.

The absolute solution for passive houses. The high thermal requirements in Europe like Passivhouse, BBC and Minergie are easily reached by 90s.

FLATSERIES

WOOD-ALUMINUM

68f windows, being clad with aluminum as a flat surface get integrated with modern architectural elements at exterior, while being completely natural construction products at heart.



68f

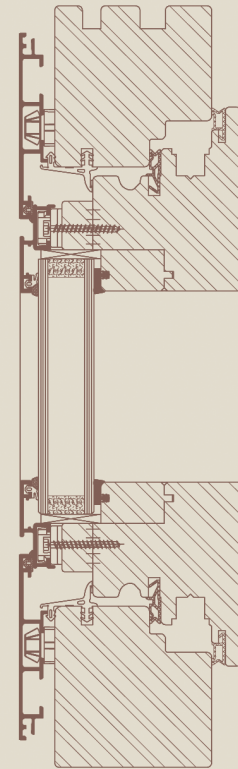

68 mm

| 68f U _w VALUE TABLE | | |
|--------------------------------|-------|-------|
| U _f = | 1,3 | |
| ψ _g = | 0,028 | 0,097 |
| | 0,6 | 1,08 |
| ψ _g = | 0,7 | 1,14 |
| | 0,031 | 0,092 |
| 1,0 | 1,18 | 1,33 |
| 1,1 | 1,24 | 1,40 |
| 1,3 | 1,38 | 1,53 |
| 2,6 | 2,24 | 2,39 |
| 2,7 | 2,31 | 2,46 |
| Max glazing = | 52 mm | |

The versatility of design lets us integrate double as well as triple insulation glass units with laminations upto 52 mm total thickness. Thermal and sound insulation values are very high with 68f windows, thanks to the three peripheral and continuous joints of EPDM and Q-LON. Please refer to our technical documentation for further details.

MINIMASERIES

WOOD-ALUMINUM

68m windows have their sashes concealed. The aluminum cladding stand as a single surface at the exterior. The patented joint line between sash and frame offer very high performance of insulation.



68m

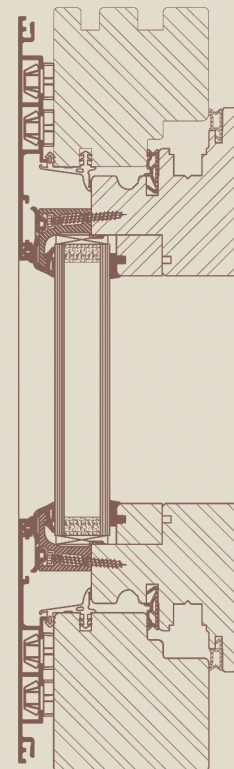

68 mm

| 68m Uw VALUE TABLE | | |
|----------------------|------------------|---------------------------|
| U _f = | 1,2 | |
| b _f = 0,6 | ψ _g = | 0,028 0,097 |
| | | 0,86 1,04 |
| b _f = 0,7 | ψ _g = | 0,93 1,10 |
| | | 0,031 0,092 |
| | 1,0 | 1,14 1,30 |
| | 1,1 | 1,21 1,36 |
| | 1,3 | 1,35 1,50 |
| | 2,6 | 2,23 2,38 |
| | 2,7 | 2,30 2,45 |
| Max glazing = | 52 mm | |

The 68m windows epitomize the spirit of challenge for Fenex. Astonishingly high performances are reached while keeping a clear and simple appearance. The three periphic and continuous joints of EPDM and Q-LON guarantees excellent tightness against air and water. Please refer to our technical documentation for further details.

ANTIQUESURFACE

“Antique Surface” is a special technique of Fenex, which emphasizes the natural texture of oak, providing an antique appearance. This is made by a mechanical process on wood surface.



ELEGANTLINES

We offer the below options of profiles for use in windows to satisfy different tastes.

EXTERIOR GLAZING BARS AND BEADS

Standard

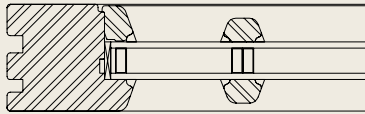

Putty

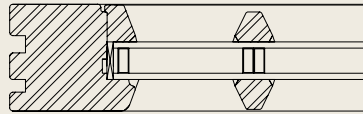

Rustic

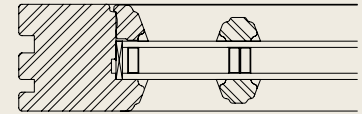

Lamb's tongue

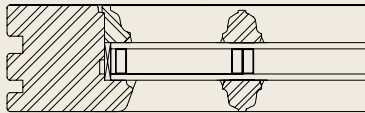

Ogee

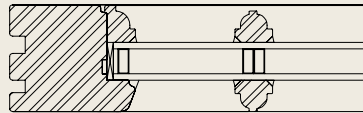

Concave

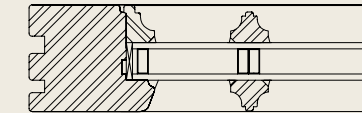



 **FENEX**
WOOD WINDOWS

WINDOW MODELS

It is practically certain that there is a suitable window solution at Fenex for every opening. Since one will usually find more than one alternative, it is important to determine requirements well.

Although wood provides wider possibilities than uPVC, there are still dimensional limitations that should be taken into consideration about Fenex products. These limitations are meant to ensure the lifetime maintenance of vital window functions. Our sales representatives will direct your preferences in these ways.



Our production capabilities are not limited to these windows. Any window you imagine means an "order" for us to fabricate. Please consult us to undertake your needs for special windows beyond our standard models.

STANDARD WINDOWS

Here, you can find several examples of rectangular windows, commonly used in contemporary buildings.

Our standard window sashes open with espagnolettes. Sashes can be delivered with tilt and turn or simple espangolettes according to demand. As an alternative to this opening system, sash windows with vertically sliding sashes can be provided in the scope of special production.



STUDIOWINDOWS

These windows are made to solve problems related to those flats under inclined roofs or just to fulfill extra-ordinary architectural tastes.

Our standard window sashes open with espagnolettes. Sashes can be delivered with tilt and turn or simple espagnolettes according to demand.

Aluminum cladding, which provides life-long solution for exterior window surfaces is possible for all our windows.

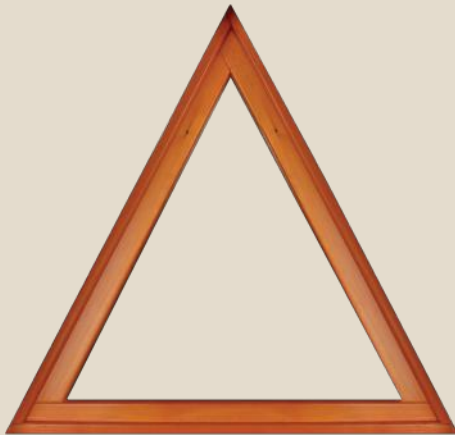
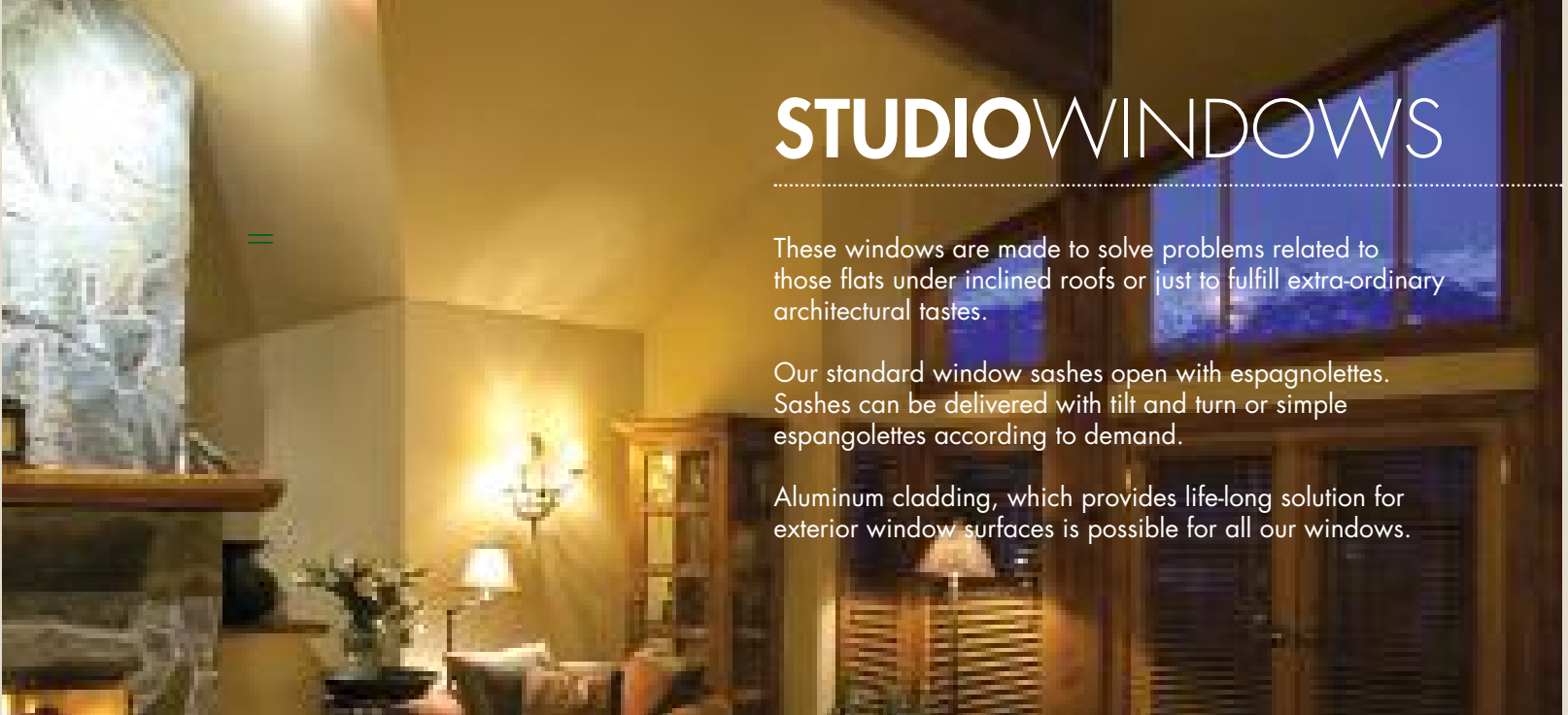

PATIO DOORS

Our patio doors have similar properties to windows in terms of construction and mechanisms but differ from other windows by the corrosion resistant doorstep system special to Fenex. On patio doors, lock keys and special handle options are provided which are not used on regular windows.

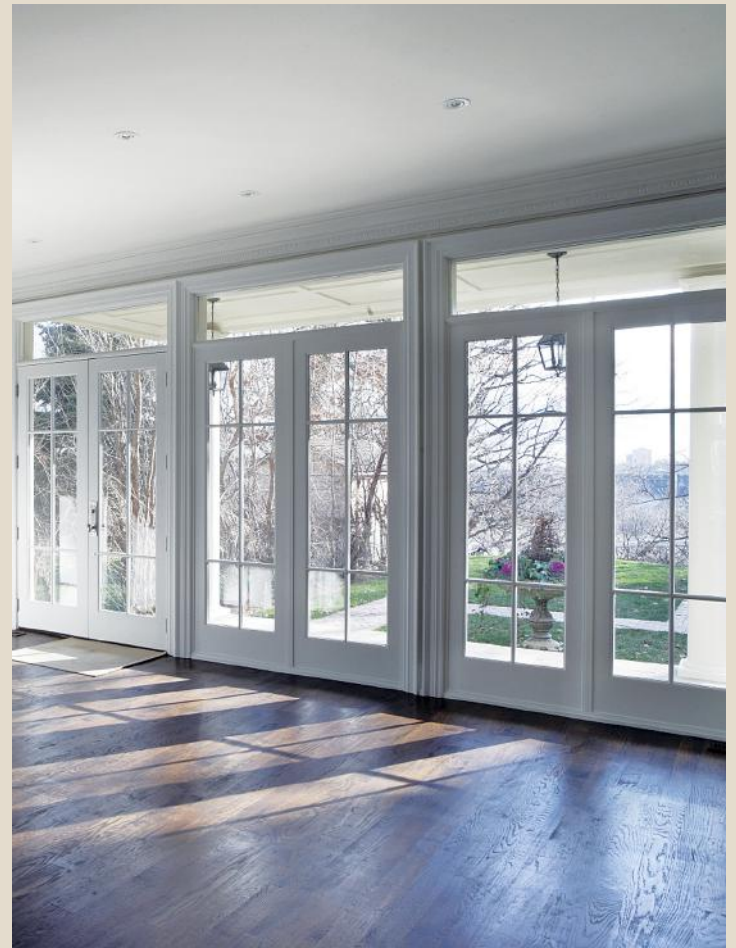

PIVOTWINDOWS

This window type is an example of the wide industrial capabilities of Fenex. Pivot windows, usually preferred as oval, may be used in children rooms for safety, in other bedrooms for privacy, in triangular under-roof wall ends or for any architectural preferences for the sake of the ambience they create.

Pivot windows are produced with special mechanisms because of their peculiar opening style.

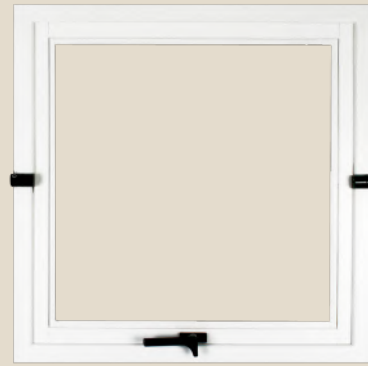

ARCHEDWINDOWS

Arched windows are extensively used in classical architecture. The arches used in ancient buildings comprises various oval shapes like a circle-top transom or a semi-circle or a Gothic top. The examples you see here reflect some of these cases.



SLIDERS

It is possible to utilize wide openings thanks to sliding window and door systems. Saving space, maximizing view and obtaining an outdoors feeling inside are among the advantages provided by sliding windows. Sliding systems are commonly preferred for doors opening to patios, gardens and balconies.

We offer different sliding styles with different mechanisms such as folding, lift-slide and tilt-and-slide. Decision must be made according to the expectations. Folding windows and doors have inter-hinged sashes that fold and stack smoothly on a side. Lift-slide windows and doors have strong fittings that lift the sash to slide open from a small distance to full width and may be fixed by lowering in any position. Tilt-and-slide mechanism requires moving the sash in and outwards when opening and closing. It is also possible to leave the sash in tilt position, to provide safe and secure ventilation.

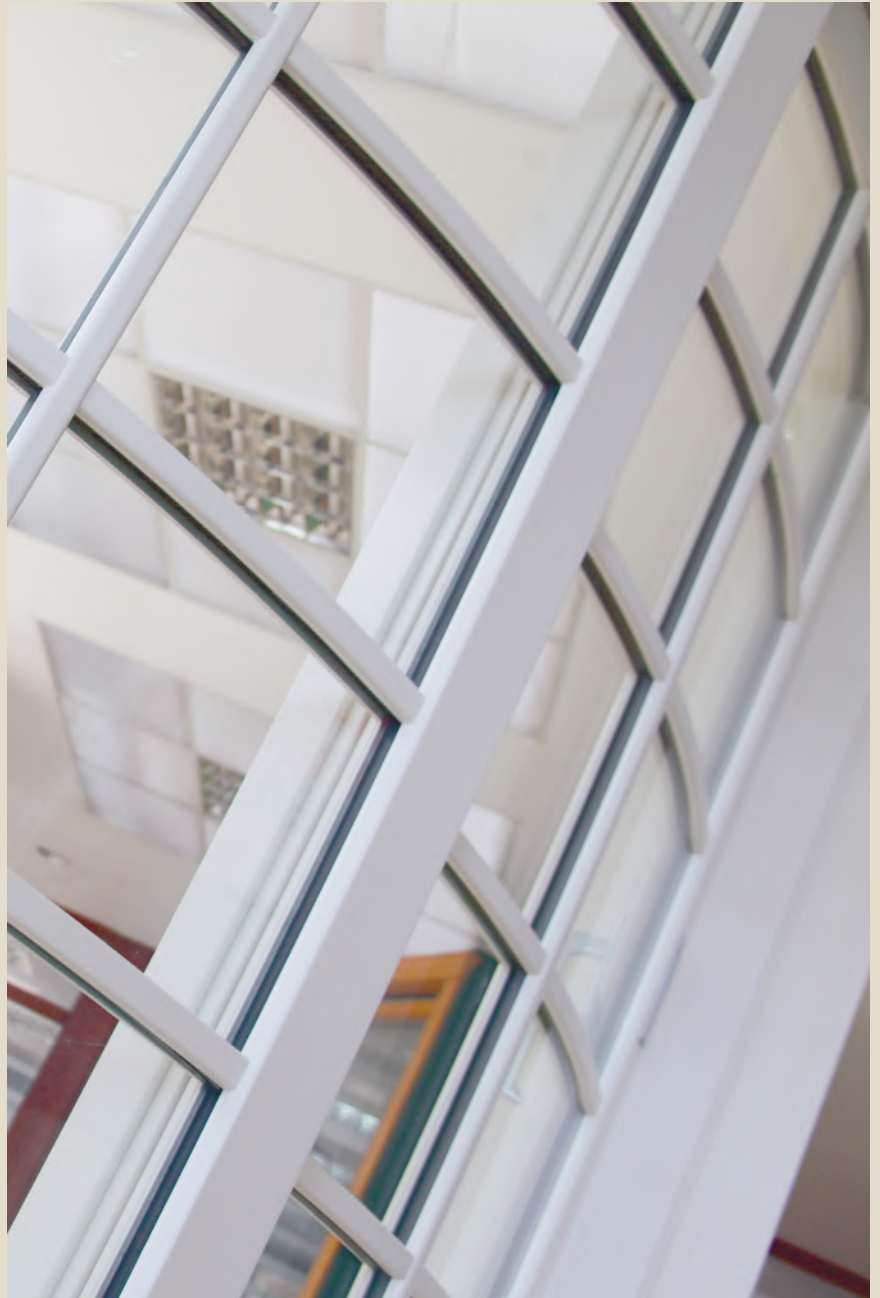

SHUTTERS

Some say that it is the shutter that makes a window beautiful. We produce improved systems of real wood shutters. They not only add to the appearance to facades but also have functions of increasing security and protecting windows against sun.

Our shutters can be locked both at open and closed positions. The louvers may be fixed or tilt. Tilting louvers enable to control sunlight and vision even with the shutter in closed position.



SASHWINDOWS

Windows with vertically moving sashes are called "Sash Windows".

Modern mechanisms have made sash windows as practical and safe to use as they have never been before.

Besides being used in period buildings, sash windows are also employed in new residences for the sake of practicality and architectural concerns all around Europe.

The traditional way to move a sash is to use cords and weights.

A modern mechanism, consisting of stainless steel springs placed in a pipe of 16-26 cm diameter is able to move a 45 kg sash simply by your fingers and to leave it at any position you like. Historical sash mechanisms, on the other hand, continue to draw attentions with many examples still working on period buildings from 19th and 18th centuries.

The common practice in many countries is to conserve period buildings by controlling renovation works and therefore, replacement of historic windows must replicate the detailing of the originals. FENEX manufactures sash windows with modern mechanisms for both contemporary and historic buildings.

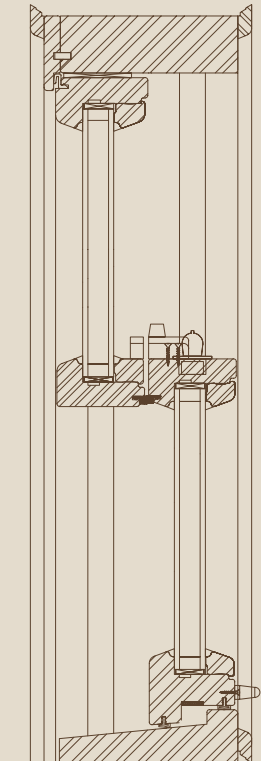

TILT AND SLIDE SASH WINDOWS

Cleaning may be difficult for sash windows.

Tilting double hung windows incorporate sashes that tilt smoothly in. This is an addition to their normal vertical operation. Tilting enables safe ventilation and easy cleaning.

A double hung window with both sashes tilting is shown below:



ACCESSORIES

Bow Handles



Cam Lock and Keeps



Finger Pulls

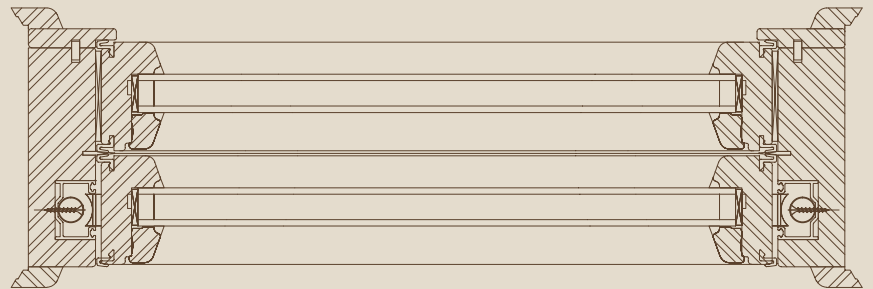
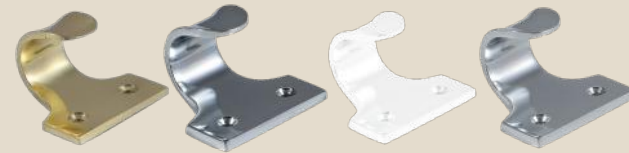

ACCESSORIES

All the accessories that, in a way, give life to a window are selected with care according to the technical requirements. What is left to the customers is only to select a handle according to her particular taste. In this section, you can make the color selection of our standard handles.



*"False" antique
espagnolette serving as
a handle to move the
real one.*

Rhapsody Bronze



Rhapsody Silber



Rhapsody Weiss



Rhapsody Champagne



Rhapsody Titan



Harmony Bronze



Harmony Weiss



Harmony Champagne



Harmony Titan

AUXILIARY WOODEN ELEMENTS

Border Profiles and Mouldings

It is possible to cover the joints between windows and adjacent walls both by means of simple border profiles and by decorative mouldings.

Our casings and frames made of "real wood" are important elements that differentiate our doors from artificial alternatives.

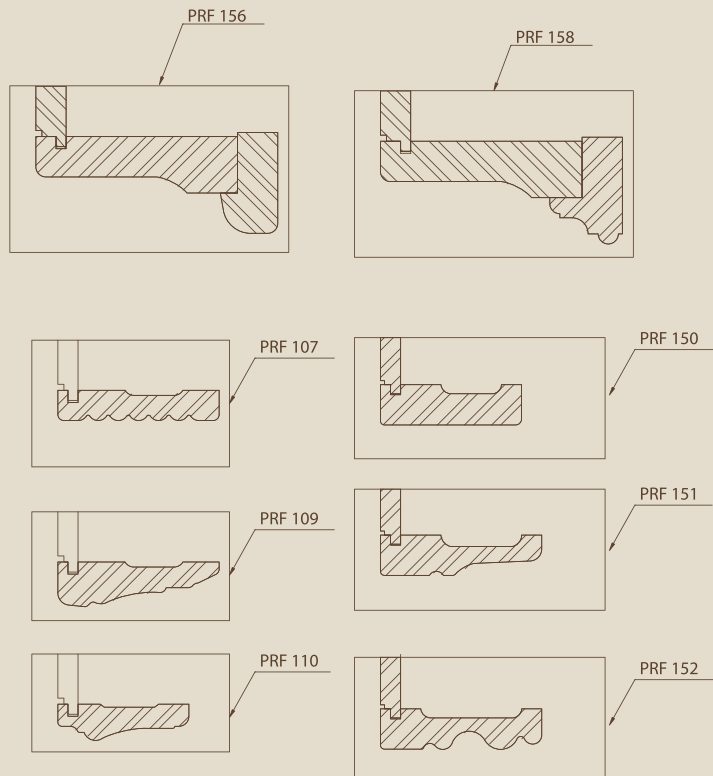

Corner Block and Header

Some people may not find the elegance achieved by a moulded casing sufficient. In this case decorative corner blocks or moulded headers may be added which will make a door the focus of home decoration.

Sills

Different sill options are available to connect the window with the below adjacent wall.

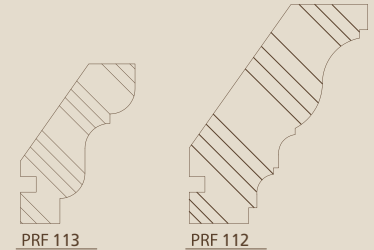

ENTRANCEDOORS

Fenex solid wood doors have an astonishingly rich variety of models. All designs are aimed to carry the distinctive character of solid wood.

Another distinction of our door range, when compared to spaced panel or fiberboard doors, is the attractive look of auxiliary-components such as the jamb and head of door frames.

In the pictures here, you will find our current models and their corresponding codes. In the context of standard production, it is possible to change the wooden panels with glass or vice-versa. Demands for stained glass are handled in the scope of special production.

All models are available in

- 68 s, 78s and 90 s series,
- MODERN DESIGN and CLASSIC DESIGN sections
- PINE RED GRANDIS and Oak
- FENEX stains and RAL colours



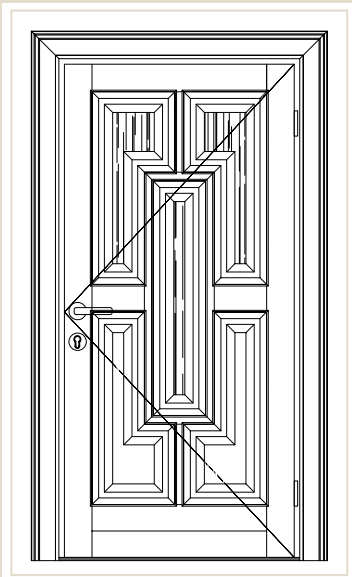

01

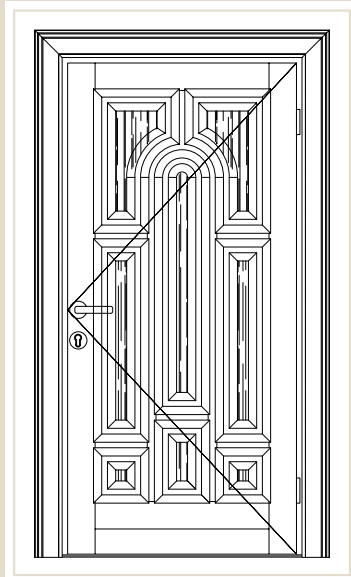

02

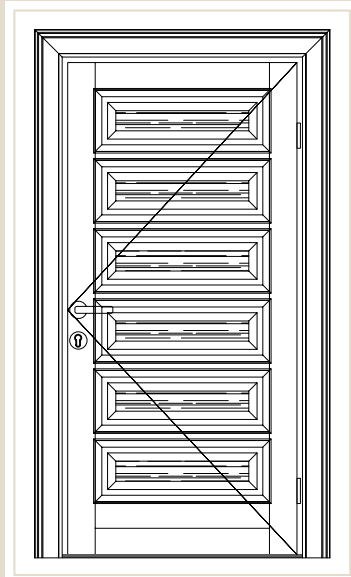

03

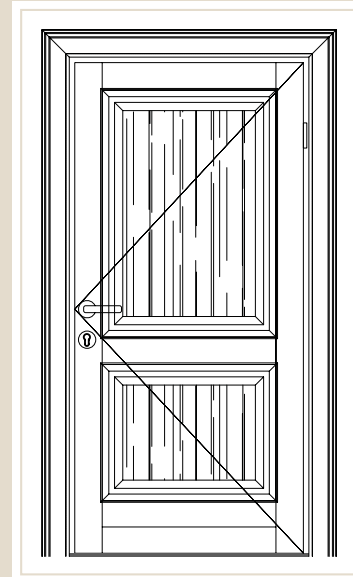

04



23

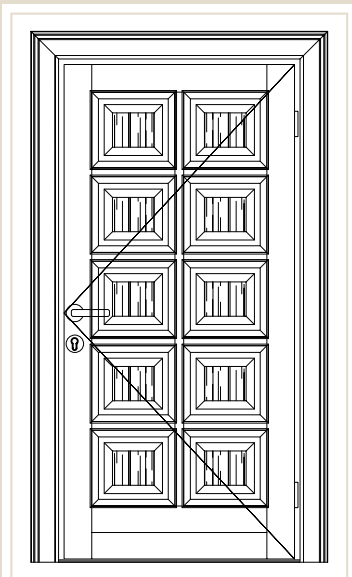

05

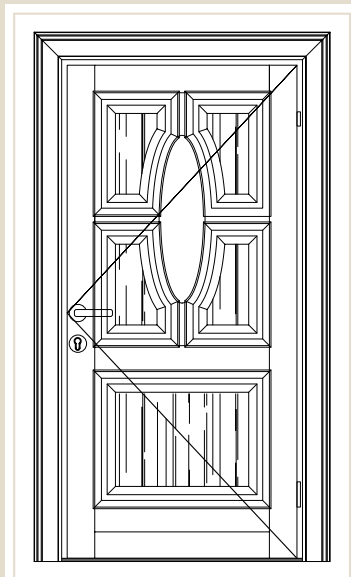

06

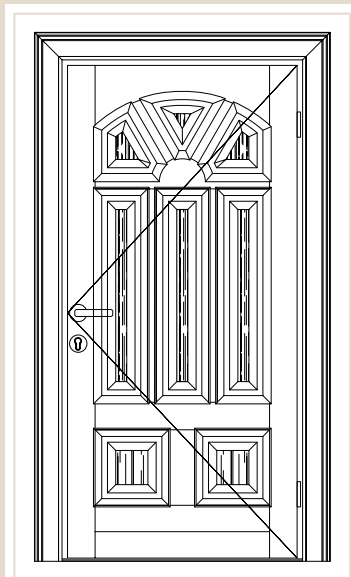

07

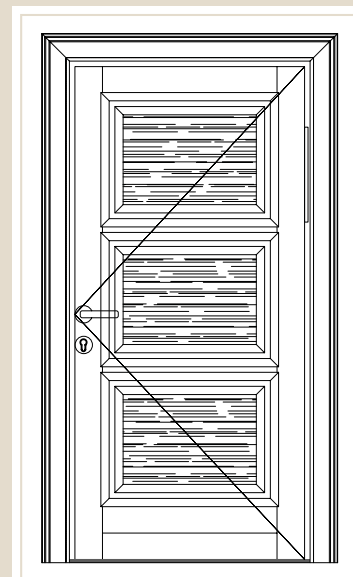

08



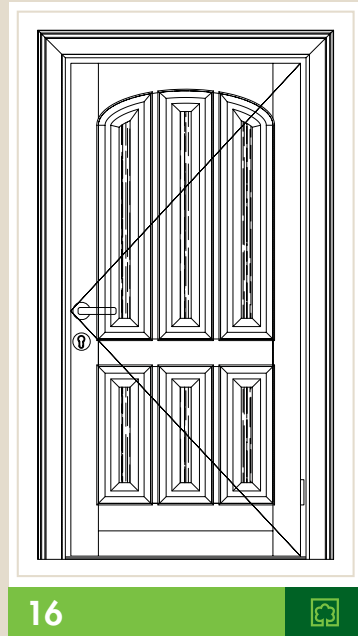
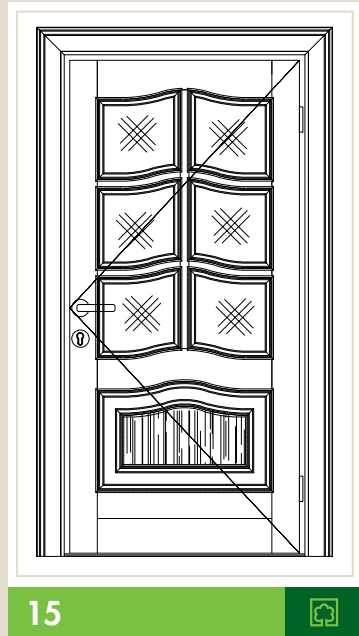
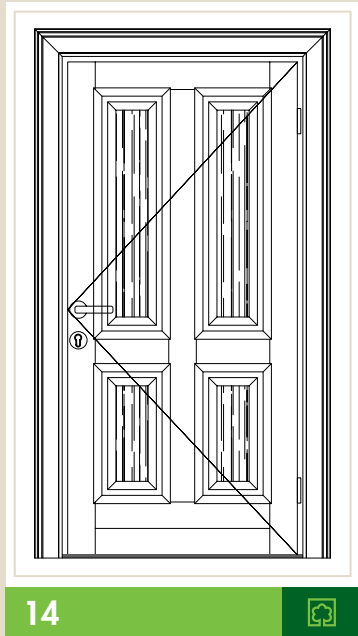
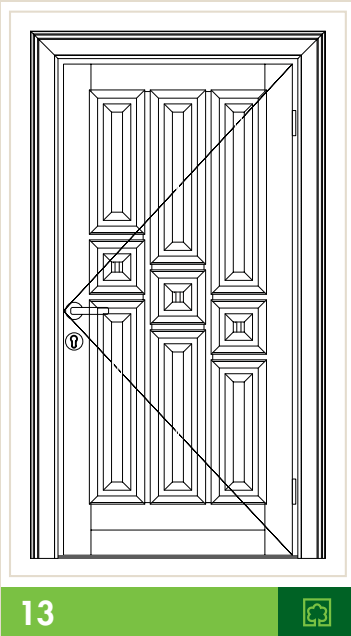
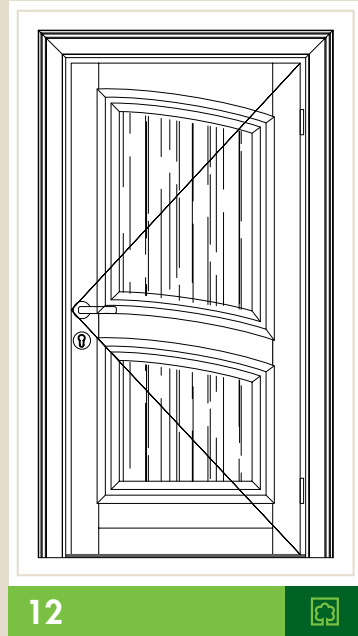
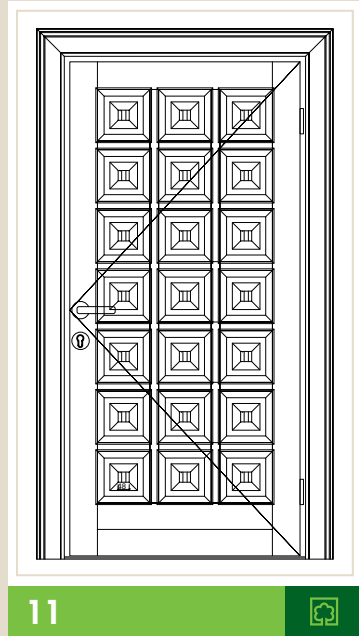
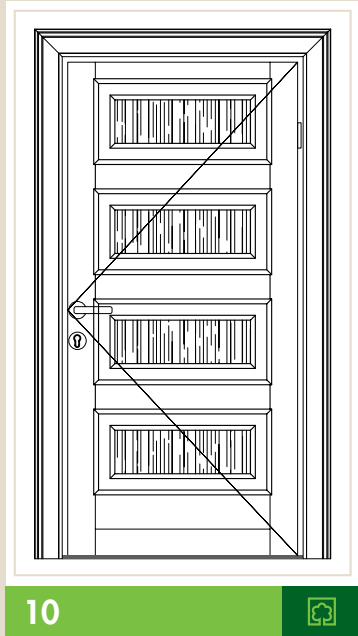
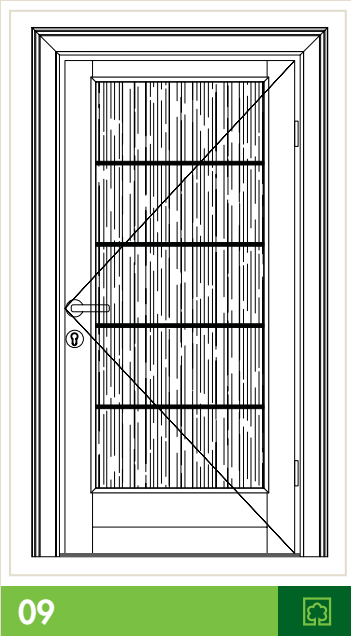

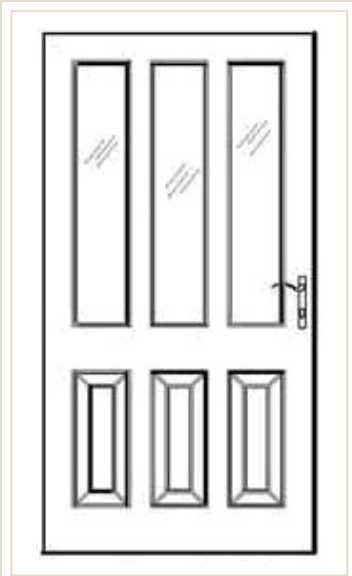

17 

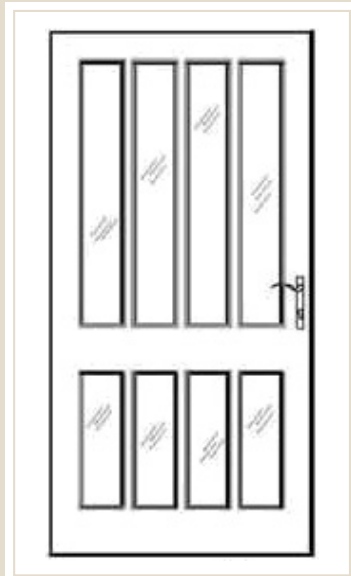

18 



19 

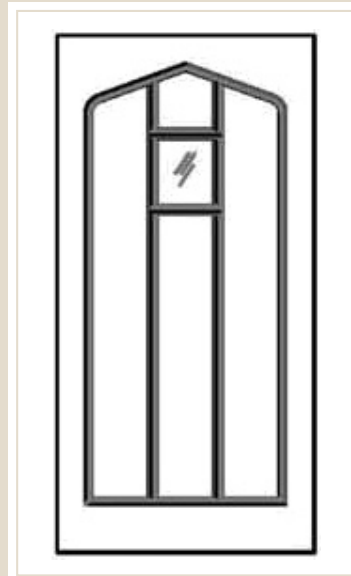

20 



21 

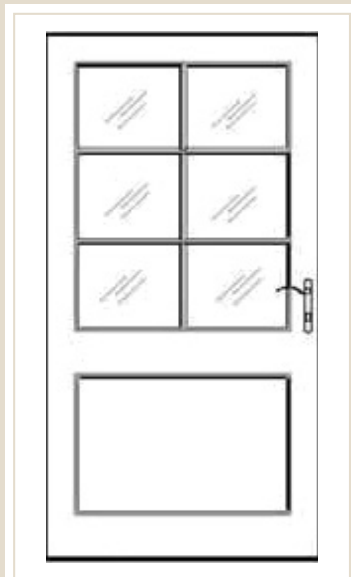

22 



23 

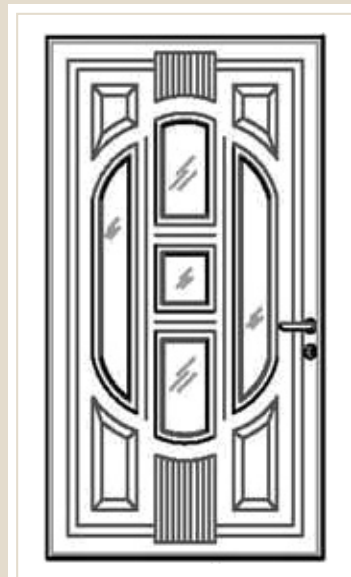

24 

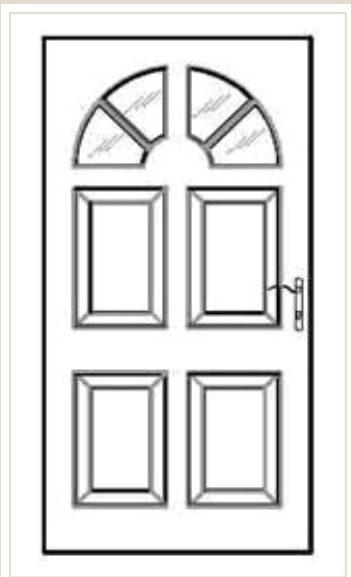

25

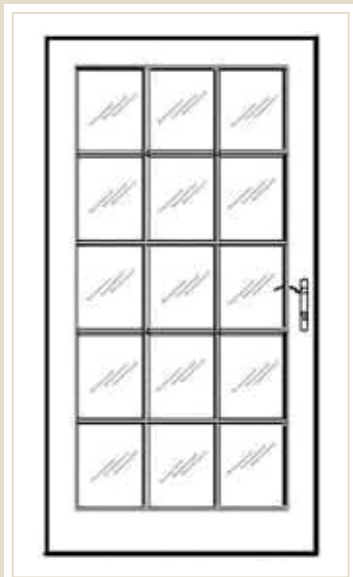

26

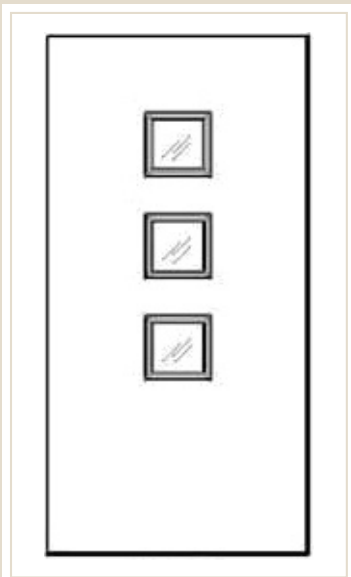

27

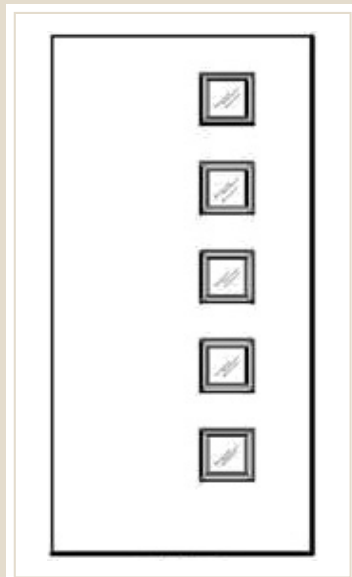

28

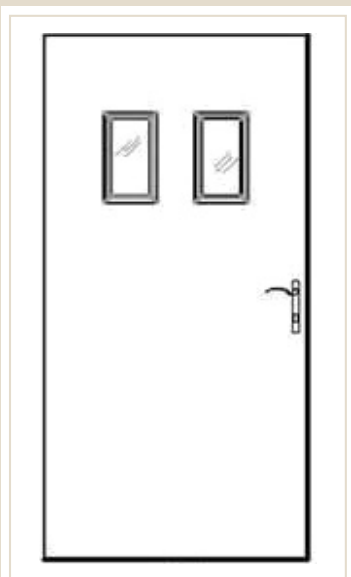

29



30

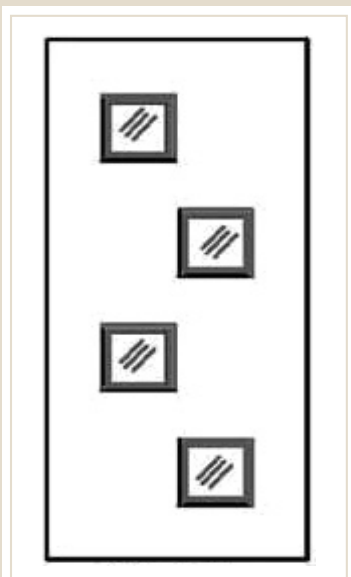

31

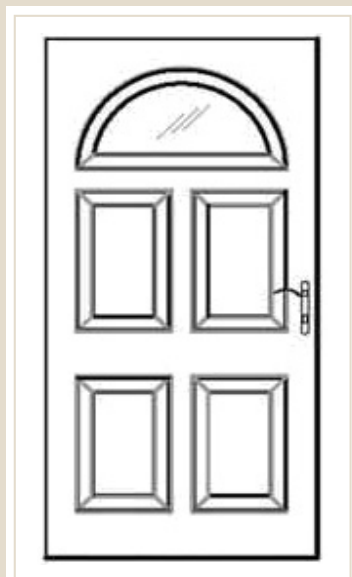

32



26



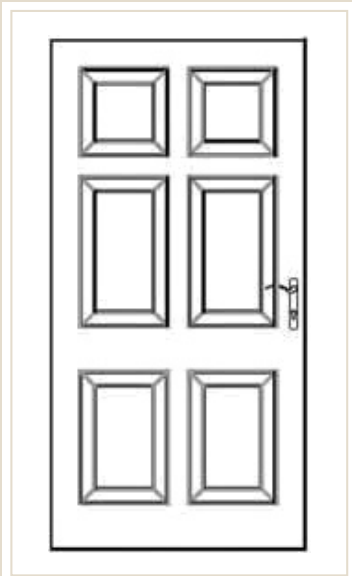

33 

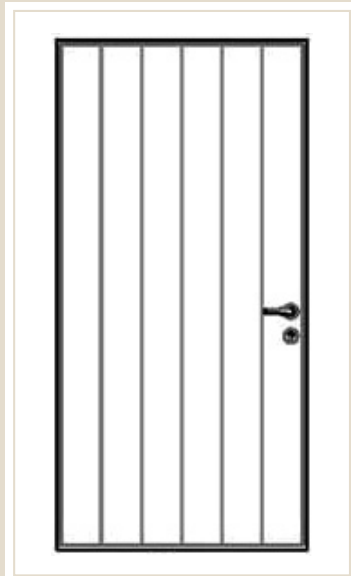

34 

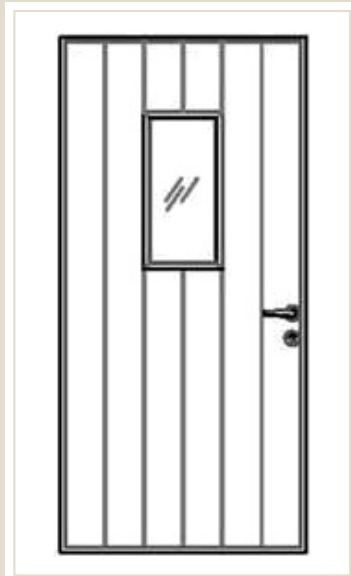

35 

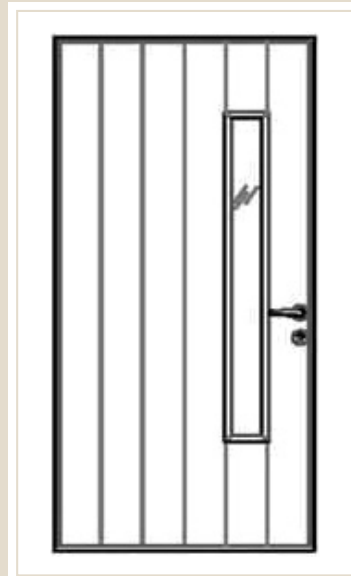

36 

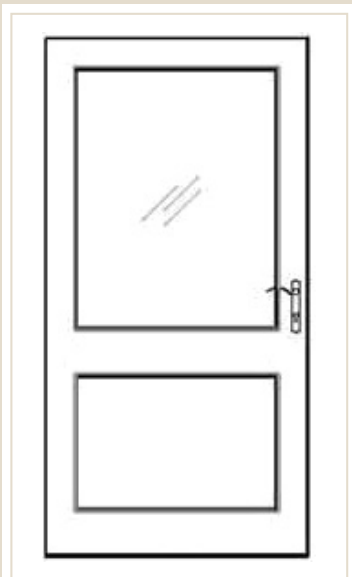

37 

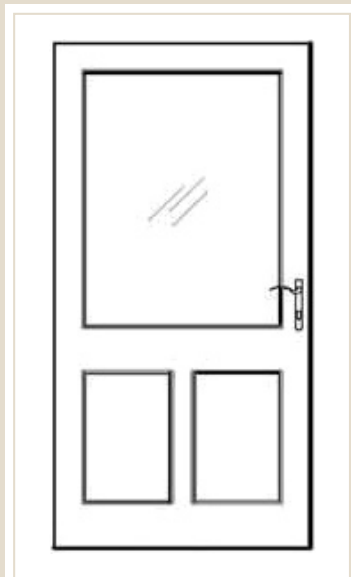

38 

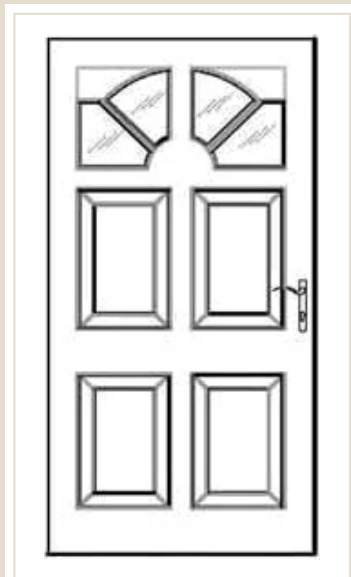

39 

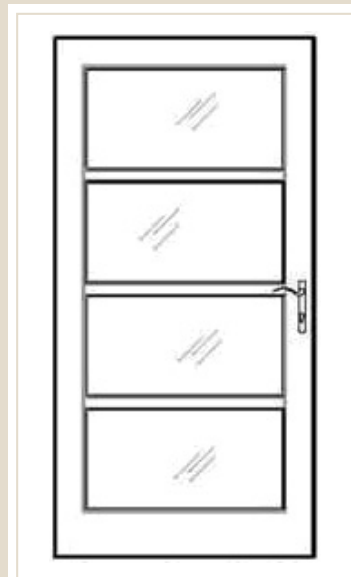

40 

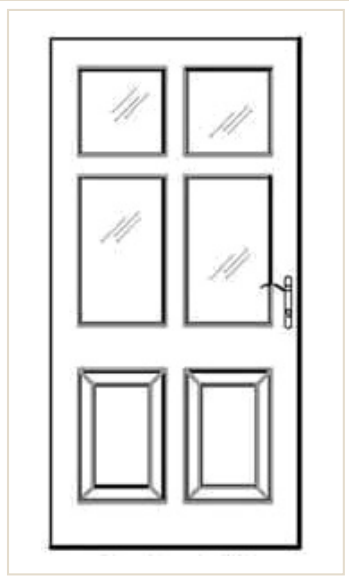

41

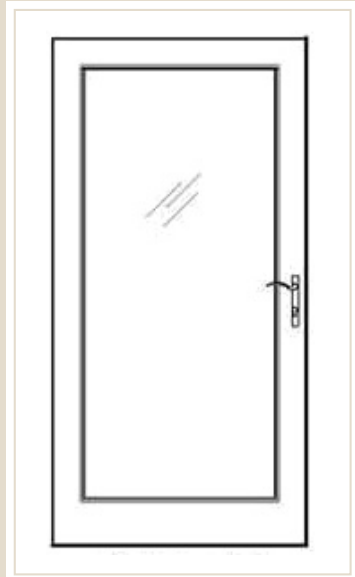

42

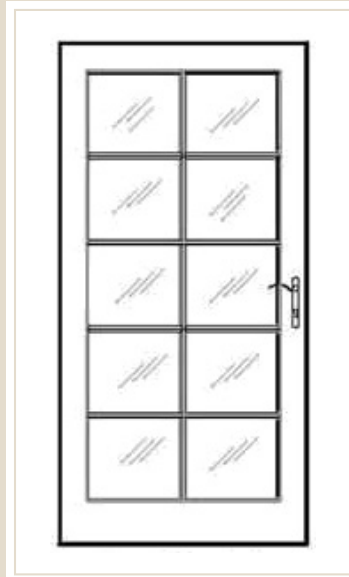

43

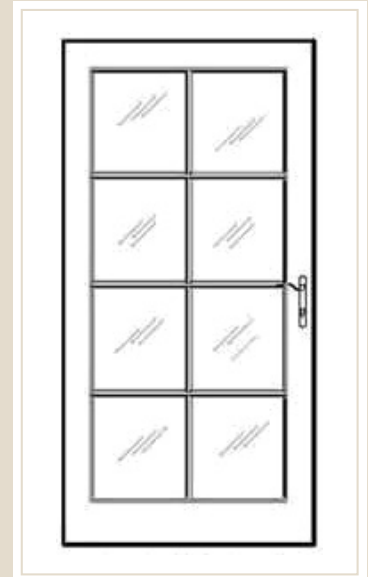

44

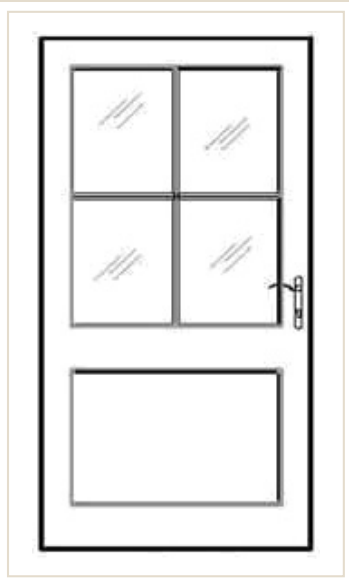

45



28



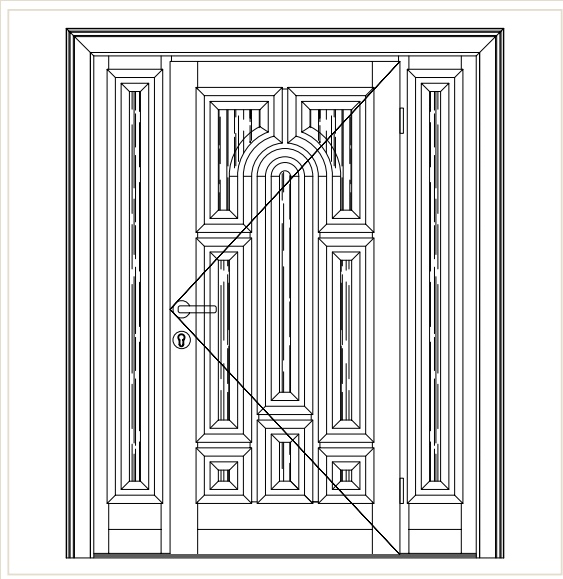

02YY

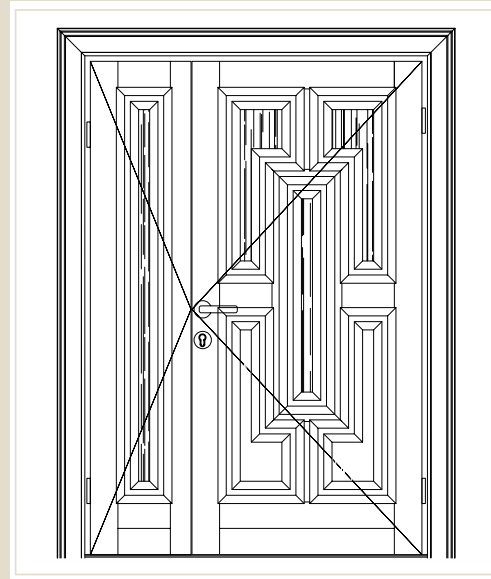

01Y

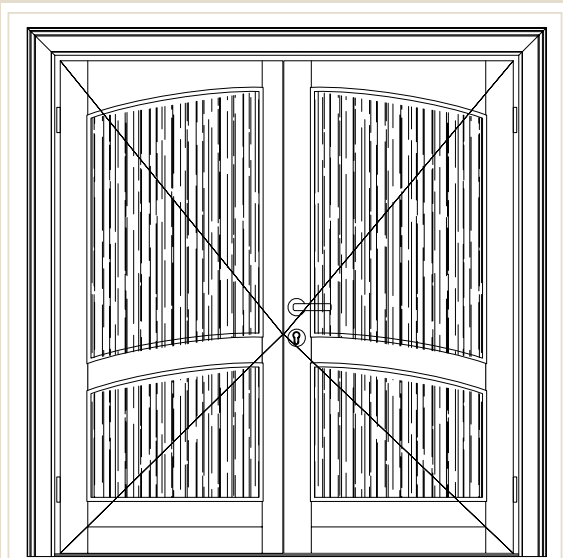

12-2

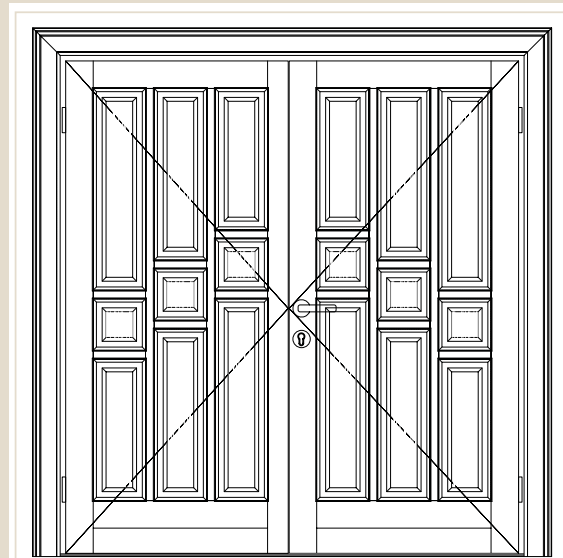

13-2



SECTIONS

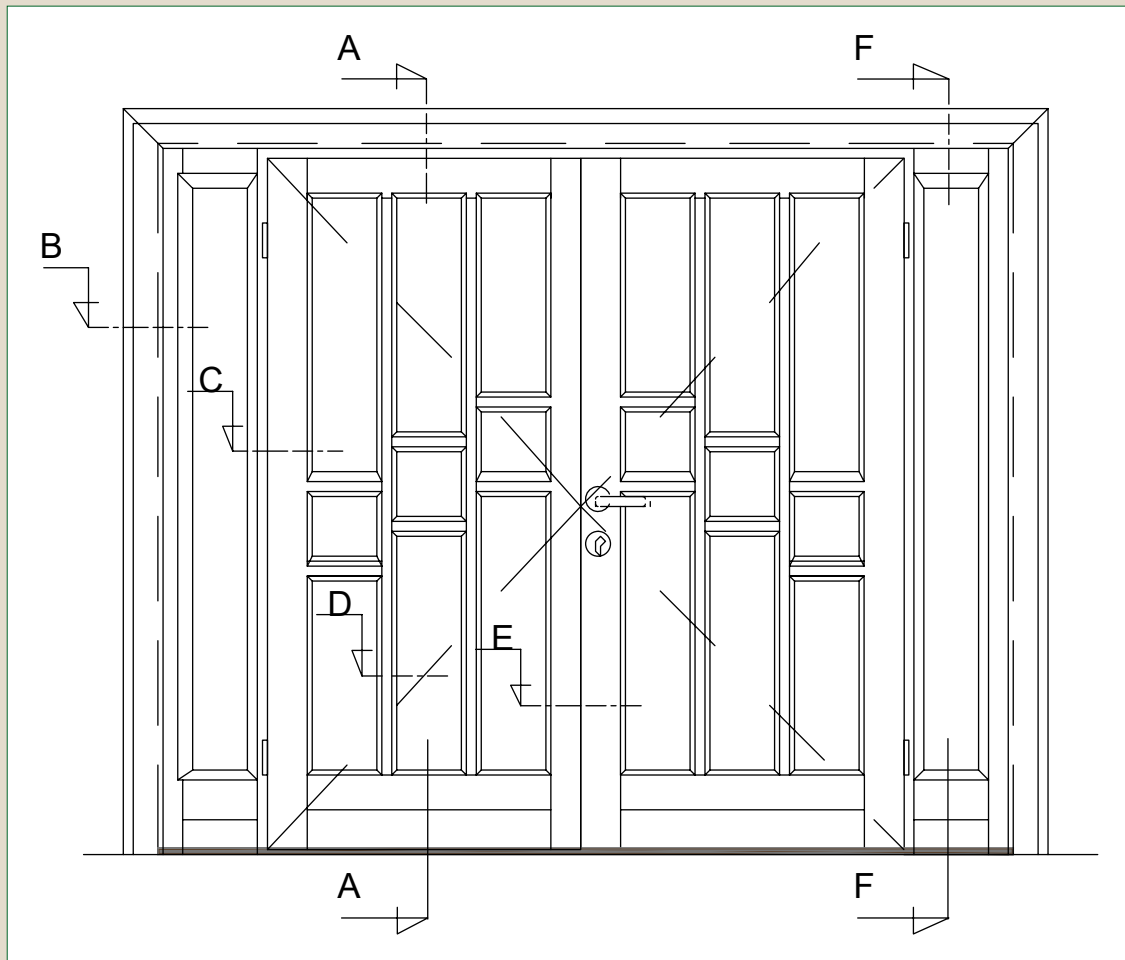

CLASSIC DESIGN

MODERN DESIGN

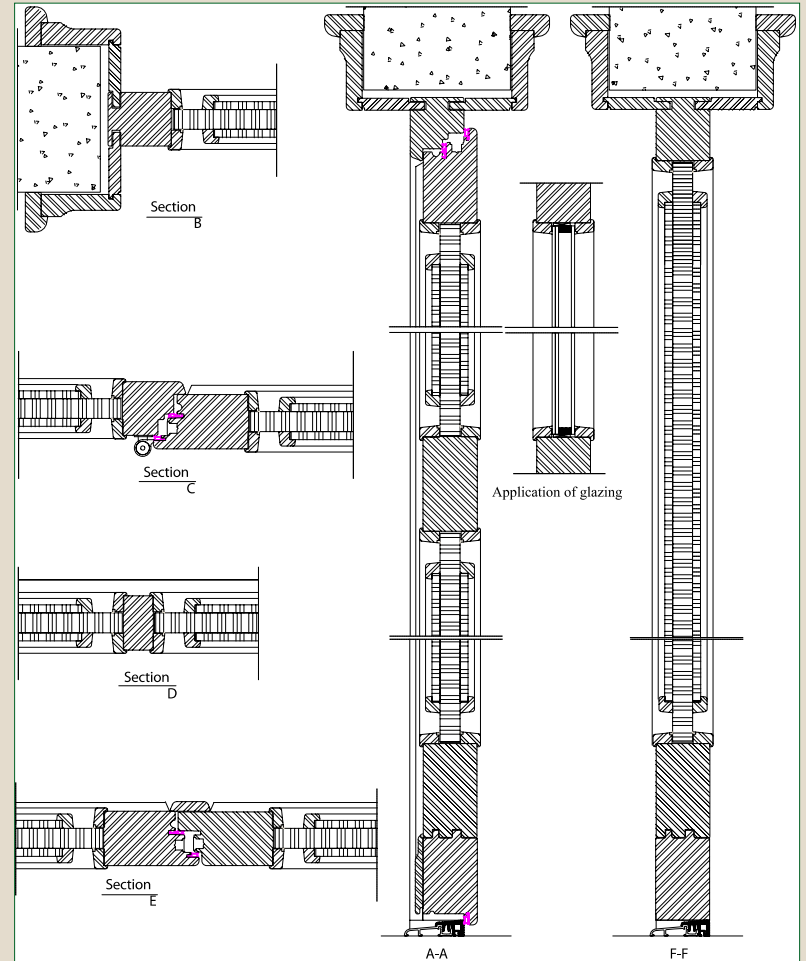
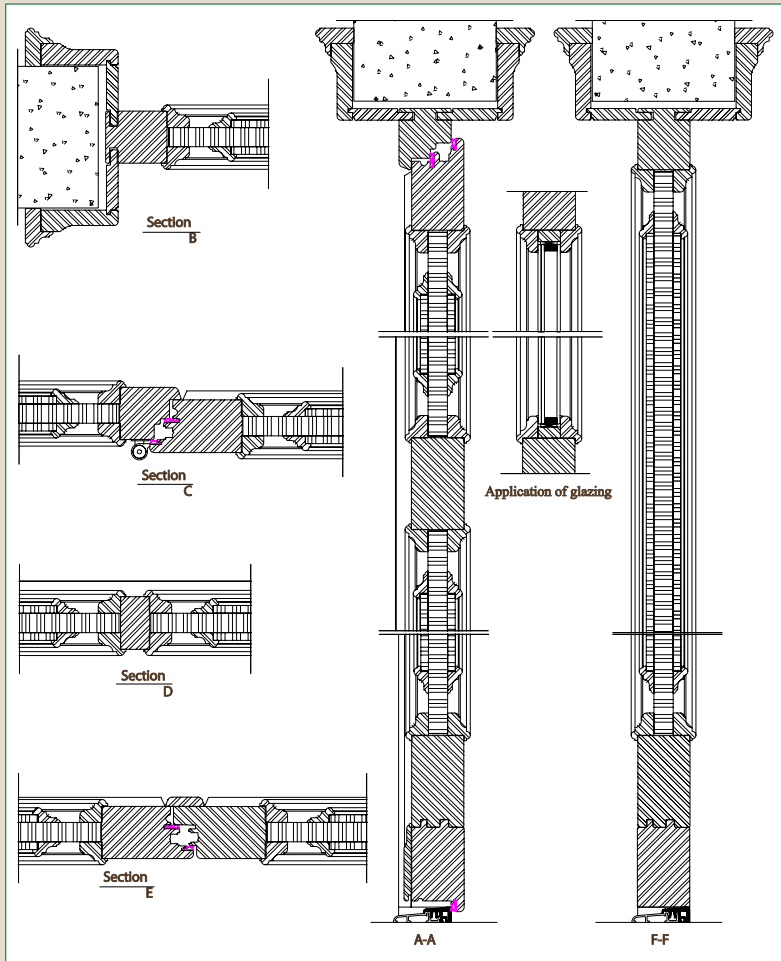

DOORHANDLES

All the hardware that, in a way, give life to a door are selected with care to the technical requirements. What is left to the customers is only to select the door knob and door handle according to her particular taste. In this section, you can make the color selection of our standard door knobs and handles.



Linea

Sogut

Anna

Accessories are available in Chrome, Nickel color options.

INTERIORDOORS

Fenex solid wood doors have an astonishingly rich variety of models. All designs are aimed to carry the distinctive character of solid wood.

In the pictures here, you will find our current models and their corresponding codes. In the context of standard production, it is possible to change the wooden panels with glass or vice-versa. Demands for stained glass are handled in the scope of special production.

Our interior doors are made of RED GRANDIS and painted in RAL colours.



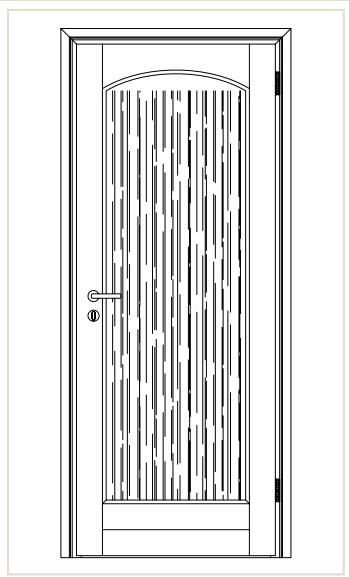

C01 

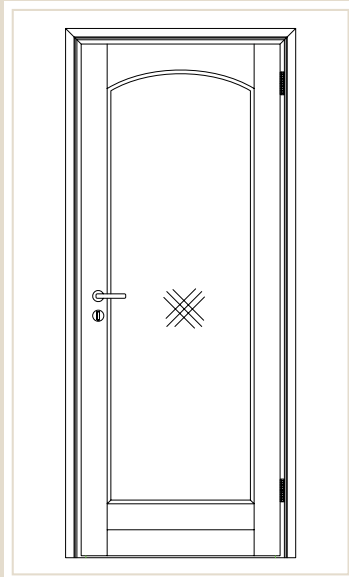

C02 

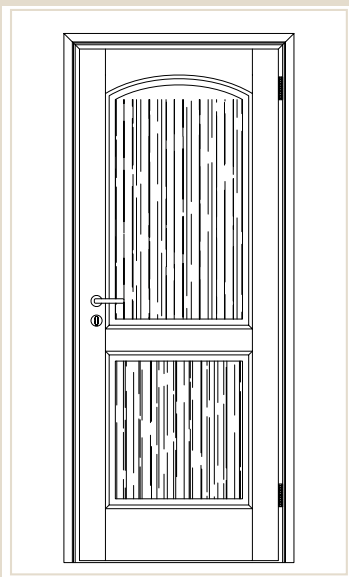

C03 

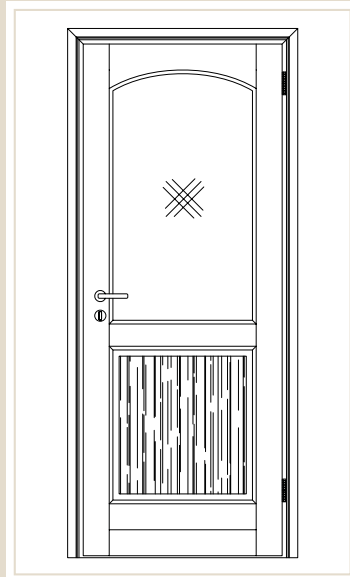

C04 

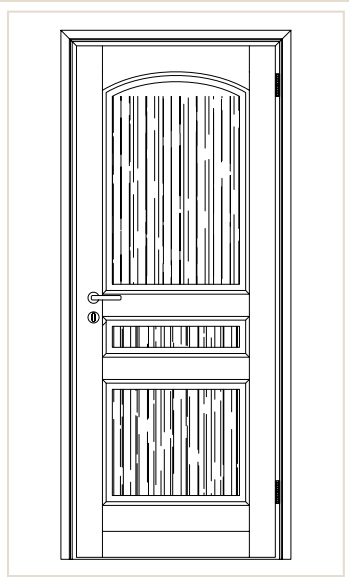

C05 

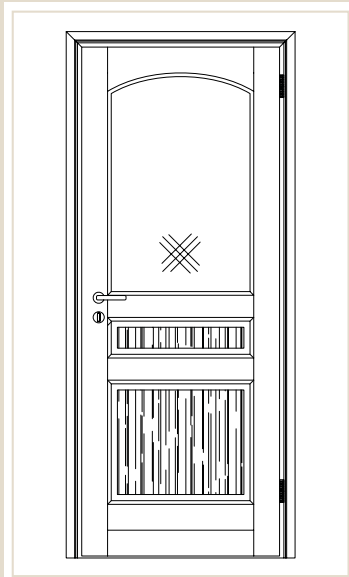

C06 

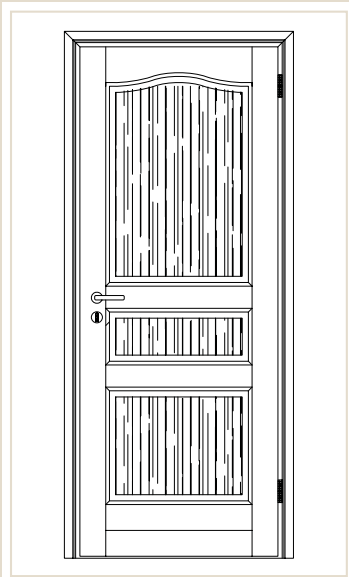

C07 

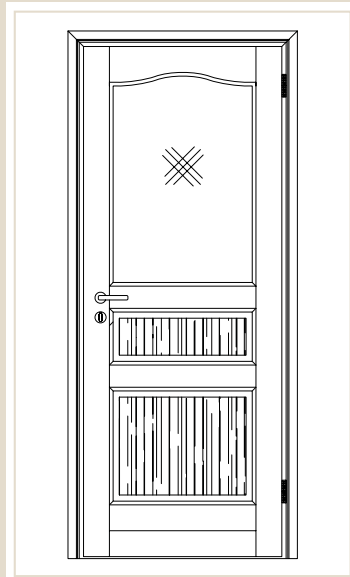

C08 

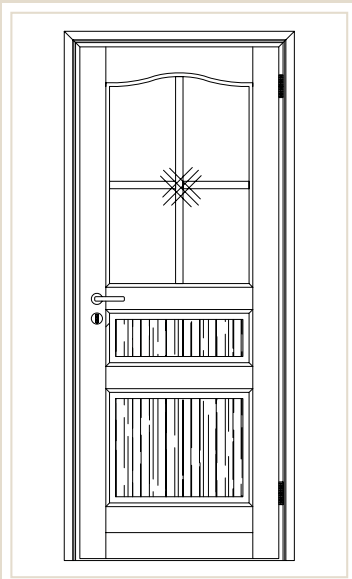

C09 

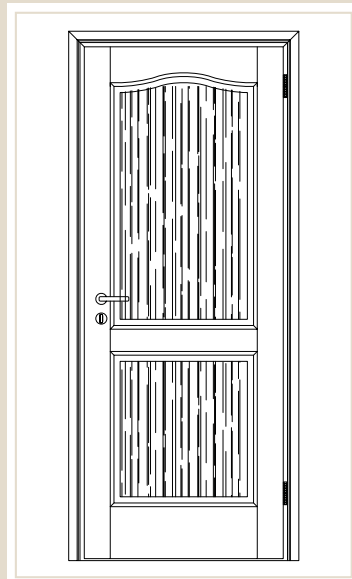

C10 

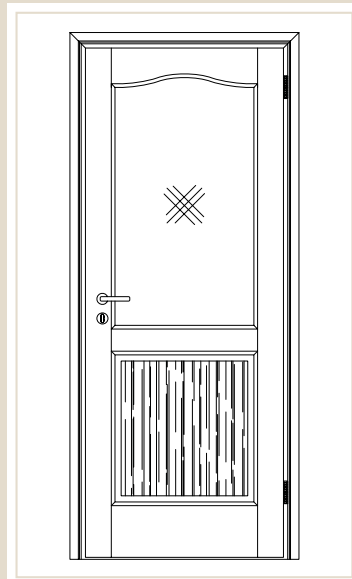

C11 

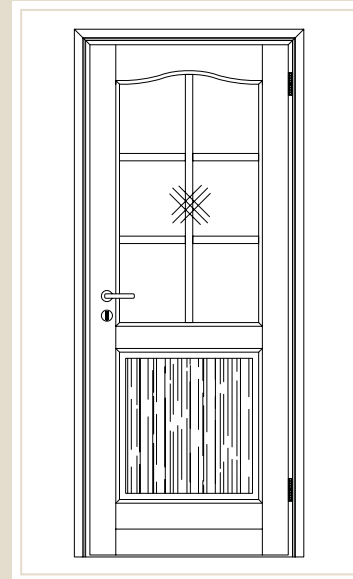

C12 

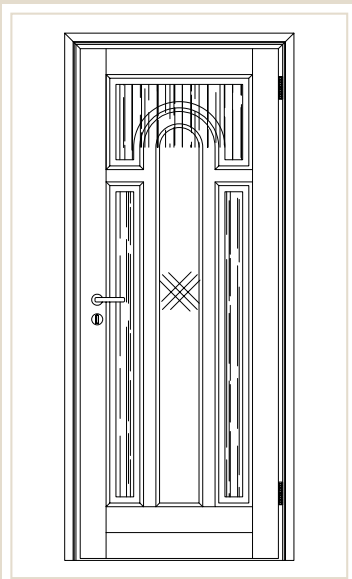

C13 

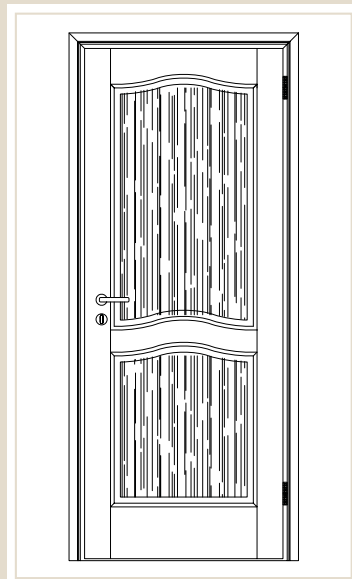

C14 

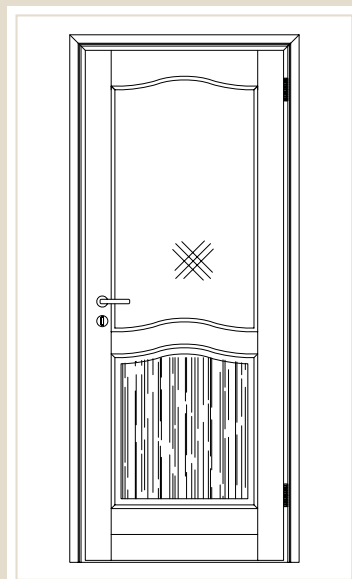

C15 

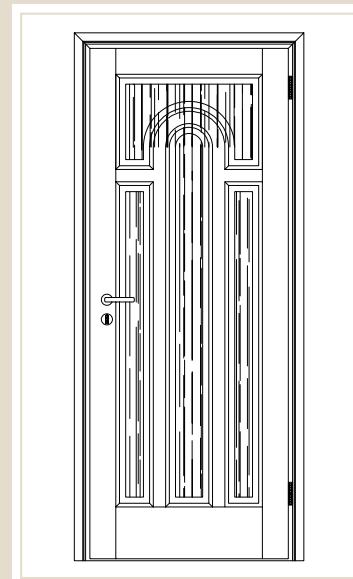

C16 

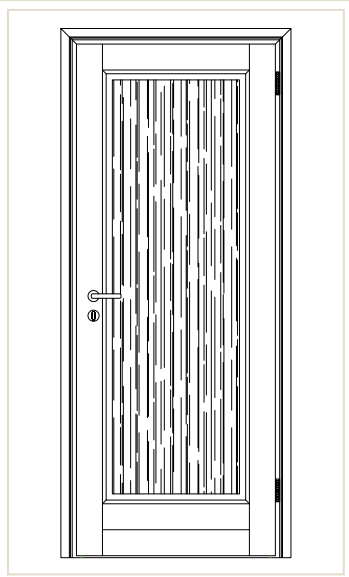

M01

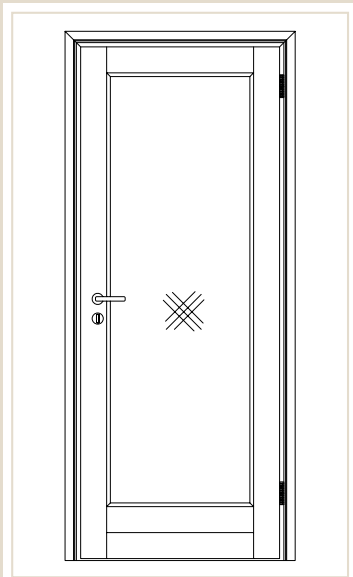

M02

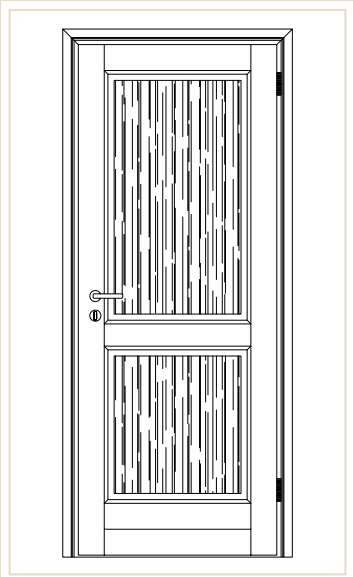

M03

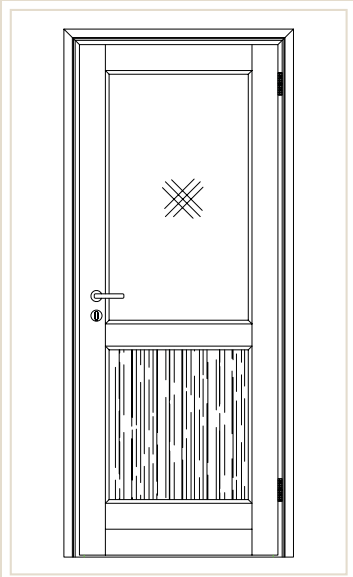

M04

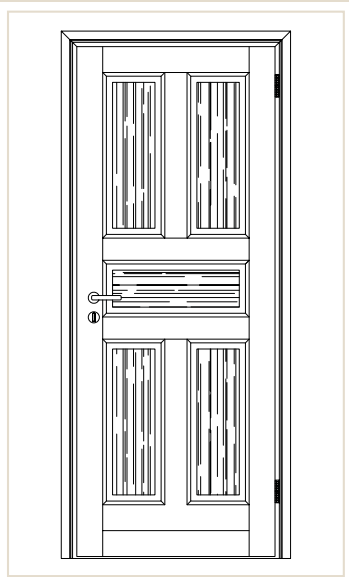

M05

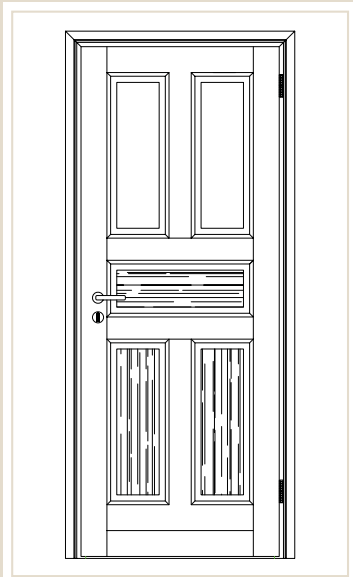

M06

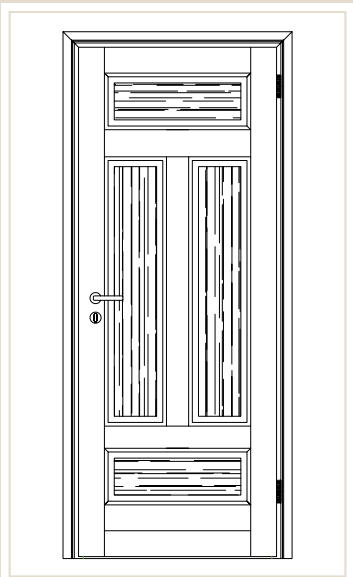

M07

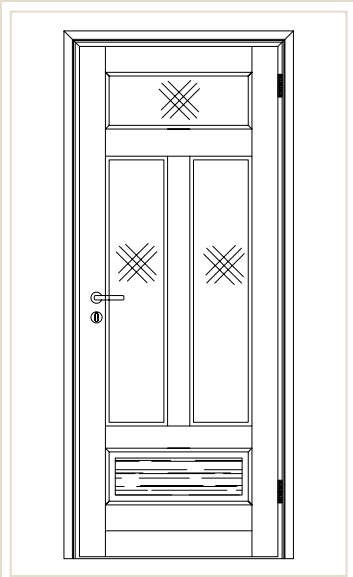

M08



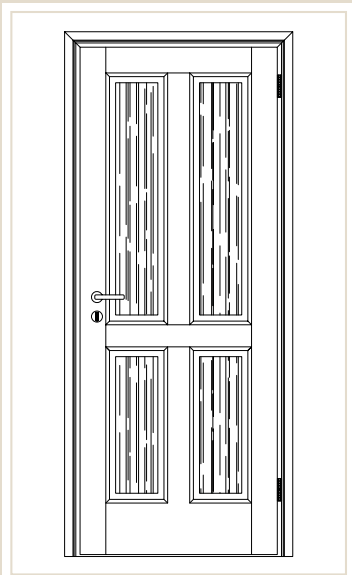

M09

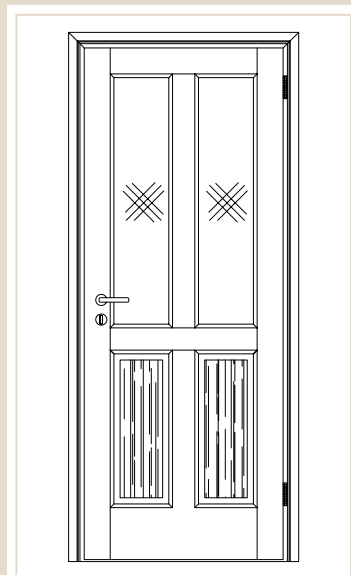

M10

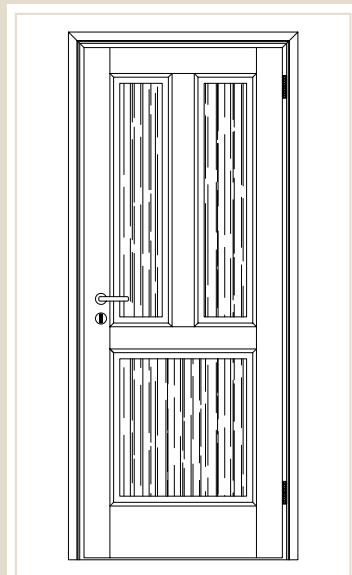

M11

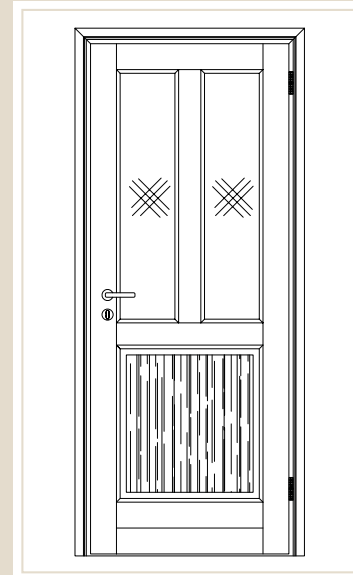

M12

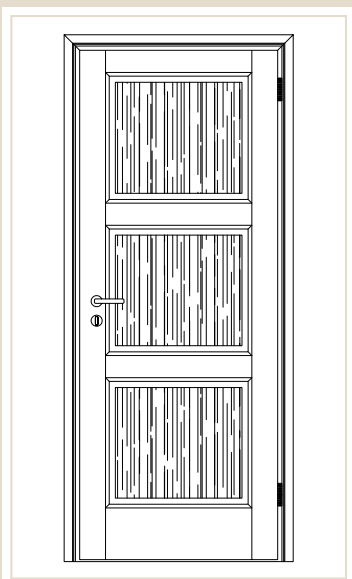

M13

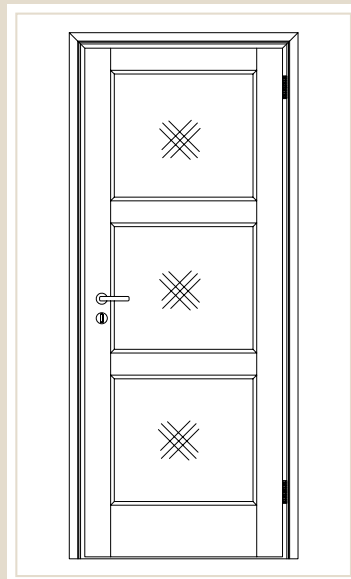

M14

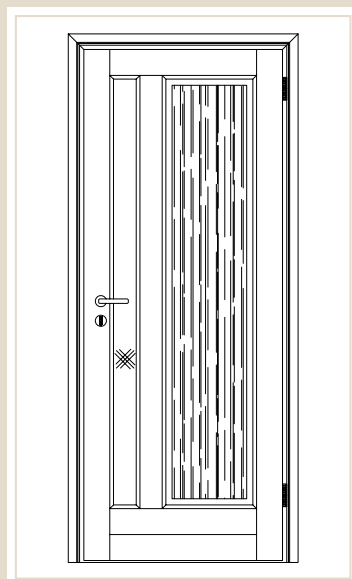

M15

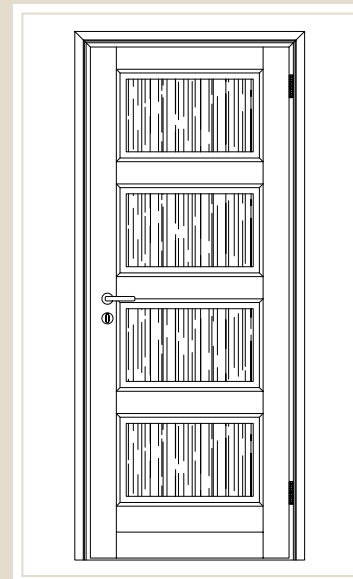

M16



SECTIONS

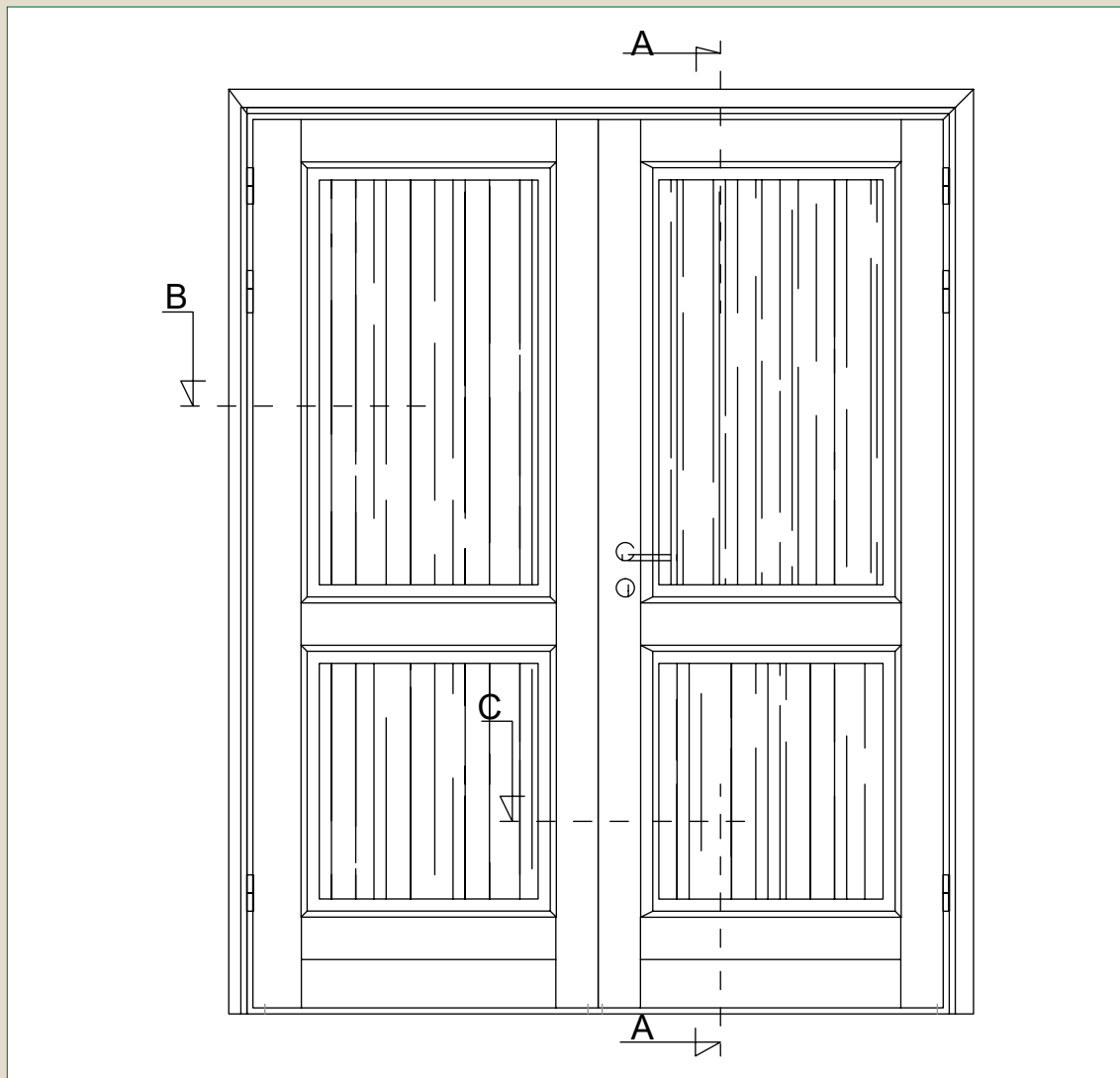

CLASSIC DESIGN

MODERN DESIGN

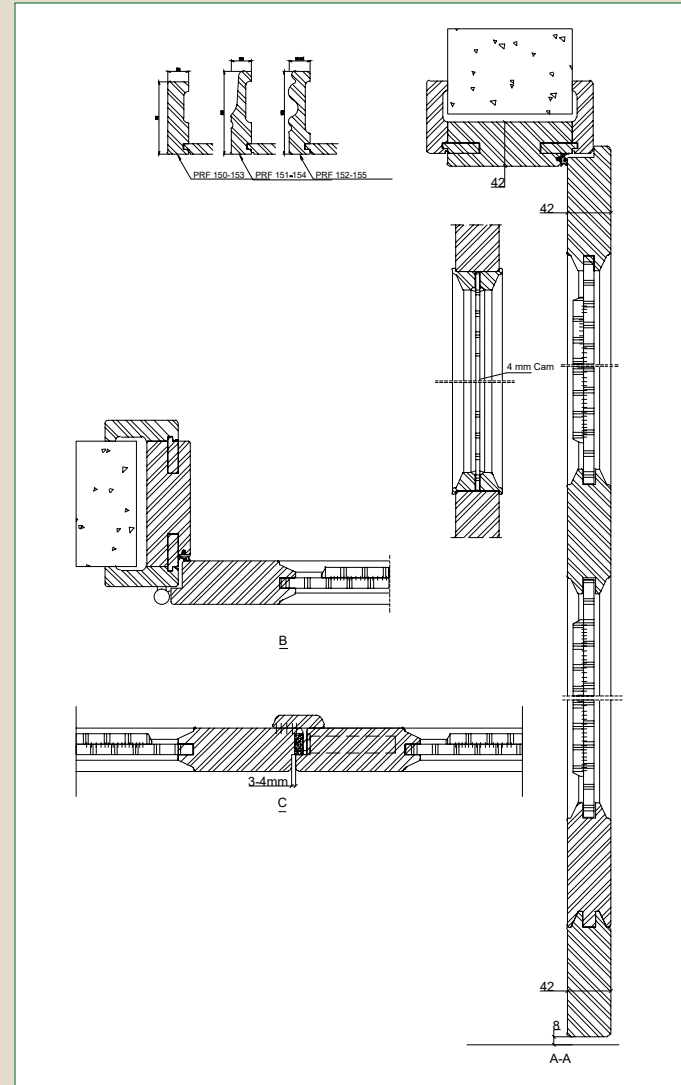
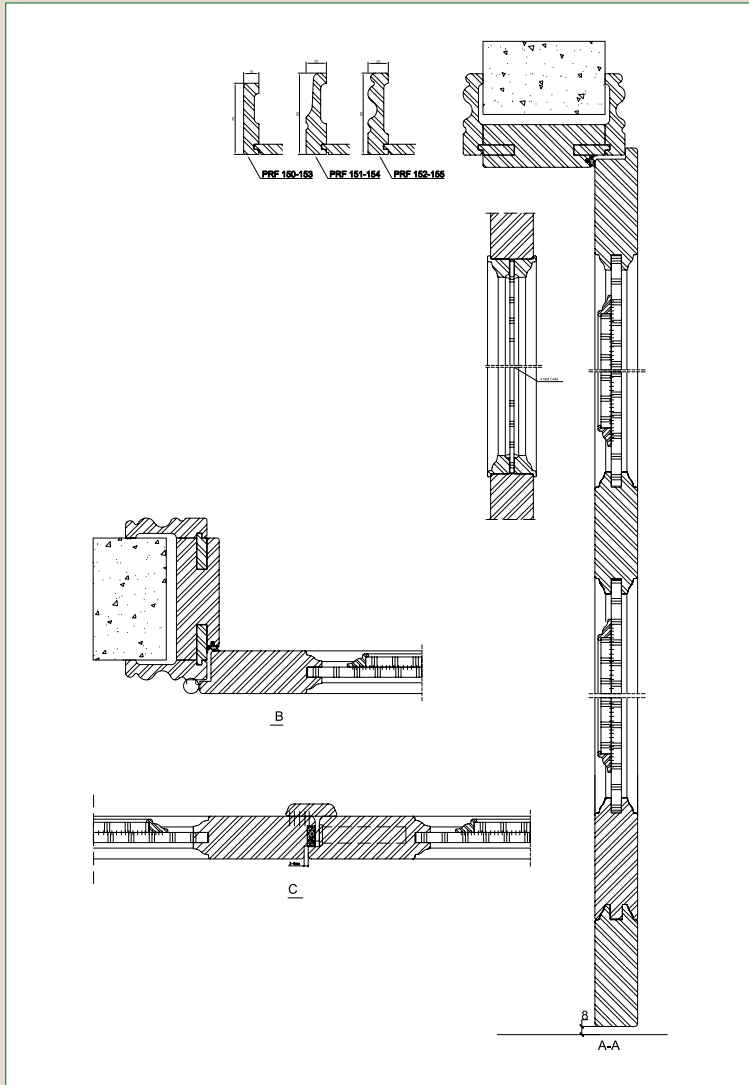

IRONMONGERY

PLATON



WERNER-K

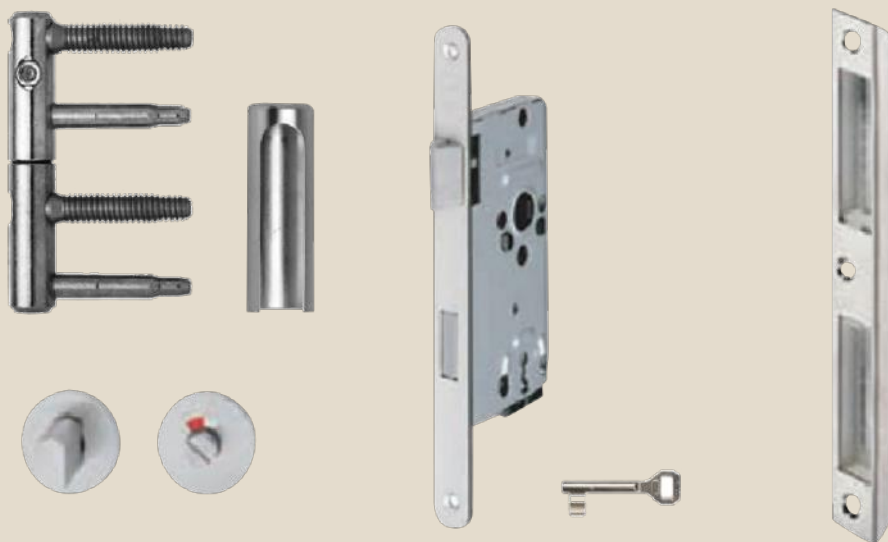
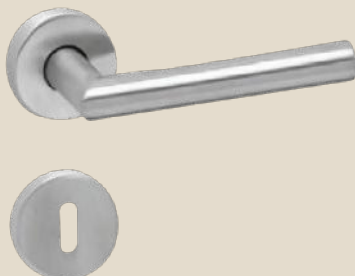

M05



M06



SUSTAINABLY SOURCED WOOD...

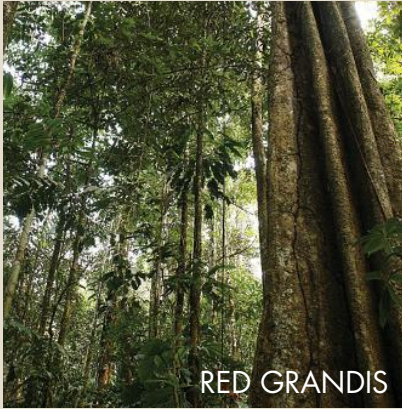

RED GRANDIS

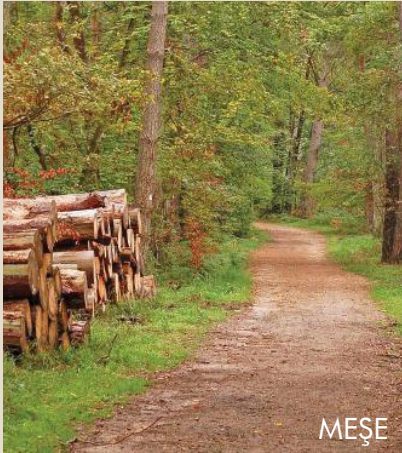

MEŞE



CAM

Fenex sources wood material from suppliers who have chain-of-custody certification by PEFC and FSC.

There are more than 5.000 tree species in the world, with different densities and other distinct properties in mechanical, thermal, acoustic and biochemical terms.

We prefer pine among conifers, dark red Red Grandis among tropicals and oak among traditional wood species. Premium quality, 3 layers laminated wood scantlings, under 12 % moisture content are used in production. All three wood species are stable in terms of deformation against temperature and humidity fluctuations. They provide excellent surface and are suitable for industrial processing.

Red Grandis, unlike many tropical species is a product of sustainable forestry and is available in standard properties. Pine is surprisingly versatile, behaving like high density woods despite its low density.



STAIN COLOURS



42



AFROMOSIA

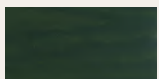

JADE



WALNUT



MAHOGANY



OAK



TEAK

Paint colours may be chosen from the complete RAL range.



*A finished project:
73 Residences with
Low Energy Consumption
in Nancy / France.*

Evidence of Performance
Advanced sound insulation of building elements

Test report No. 19-00181-PR01 (P2-01-01-01-01)

Client: **Aksoy Akıncı Yapı Elemanları**
Aksoy İnşaat Sanayi Yatırımları
Manisa / Turkey

Product: Single leaf single window

Window type: **W1**

Dimensions: 1,200 mm x 1,400 mm

Weight: 18 and 19 kg

Installation: 1. Central seal, 2. Internal seal

Measuring point: B, C and G

Measuring method: B, C and G

Measuring conditions: 1. 20°C, 2. 50% RH, 3. 0.5 m/s wind speed, 4. 0.5 m/s wind direction

Weighted sound reduction index R_w
Sound reduction index C and G

$R_w(C) C_{tr} = 29 (-2;-6) dB$

Signature: J. Kemper, P. Nuss

Evidence of Performance
Advanced sound insulation of building elements

Test report No. 19-00181-PR01 (P2-01-01-01-01)

Client: **Aksoy Akıncı Yapı Elemanları**
Aksoy İnşaat Sanayi Yatırımları
Manisa / Turkey

Product: Single leaf single window

Window type: **W1**

Dimensions: 1,200 mm x 1,400 mm

Weight: 18 and 19 kg

Installation: 1. Central seal, 2. Internal seal

Measuring point: B, C and G

Measuring method: B, C and G

Measuring conditions: 1. 20°C, 2. 50% RH, 3. 0.5 m/s wind speed, 4. 0.5 m/s wind direction

Weighted sound reduction index R_w
Sound reduction index C and G

$R_w(C) C_{tr} = 28 (-1;-4) dB$

Signature: J. Kemper, P. Nuss

Evidence of Performance
Advanced sound insulation of building elements

Test report No. 19-00181-PR01 (P2-01-01-01-01)

Client: **Aksoy Akıncı Yapı Elemanları**
Aksoy İnşaat Sanayi Yatırımları
Manisa / Turkey

Product: Single leaf single window

Window type: **W1**

Dimensions: 1,200 mm x 1,400 mm

Weight: 18 and 19 kg

Installation: 1. Central seal, 2. Internal seal

Measuring point: B, C and G

Measuring method: B, C and G

Measuring conditions: 1. 20°C, 2. 50% RH, 3. 0.5 m/s wind speed, 4. 0.5 m/s wind direction

Weighted sound reduction index R_w
Sound reduction index C and G

$R_w(C) C_{tr} = 41 (-2;-4) dB$

Signature: J. Kemper, P. Nuss

Evidence of Performance
Advanced sound insulation of building elements

Test report No. 19-00181-PR01 (P2-01-01-01-01)

Client: **Aksoy Akıncı Yapı Elemanları**
Aksoy İnşaat Sanayi Yatırımları
Manisa / Turkey

Product: Single leaf single window

Window type: **W1**

Dimensions: 1,200 mm x 1,400 mm

Weight: 18 and 19 kg

Installation: 1. Central seal, 2. Internal seal

Measuring point: B, C and G

Measuring method: B, C and G

Measuring conditions: 1. 20°C, 2. 50% RH, 3. 0.5 m/s wind speed, 4. 0.5 m/s wind direction

Weighted sound reduction index R_w
Sound reduction index C and G

$R_w(C) C_{tr} = 42 (-1;-3) dB$

Signature: J. Kemper, P. Nuss

ORAS

WCS
WORLD CERTIFICATION SERVICES

SERTİFİKA

Asıl Ürün: **ÇEHENK**

SELEKTION ELEKTROKİMYA SANAYİ VE TİCARET LİMİTED ŞİRKETİ
AKSOY İNŞAAT SANAYİ YATIRIMLARI
MANİSA / TÜRKİYE

ISO 9001:2008

SELEKTION ELEKTROKİMYA SANAYİ VE TİCARET LİMİTED ŞİRKETİ
AKSOY İNŞAAT SANAYİ YATIRIMLARI
MANİSA / TÜRKİYE

SELEKTION ELEKTROKİMYA SANAYİ VE TİCARET LİMİTED ŞİRKETİ
AKSOY İNŞAAT SANAYİ YATIRIMLARI
MANİSA / TÜRKİYE

SELEKTION ELEKTROKİMYA SANAYİ VE TİCARET LİMİTED ŞİRKETİ
AKSOY İNŞAAT SANAYİ YATIRIMLARI
MANİSA / TÜRKİYE

SELEKTION ELEKTROKİMYA SANAYİ VE TİCARET LİMİTED ŞİRKETİ
AKSOY İNŞAAT SANAYİ YATIRIMLARI
MANİSA / TÜRKİYE

Expert Statement
No. 19-00181-GR01-01-04-04-01

Statement of Expert Statement No. 19-00181-GR01-01-04-04-01 dated 20 September 2019

Date of Expert Statement: 20 September 2019

Client: **Aksoy Akıncı Yapı Elemanları**
Aksoy İnşaat Sanayi Yatırımları
Manisa / Turkey

Order: Expert statement on the sound insulation of a window unit

Object: Single window unit composed of wood profiles

Contents: 1. Client, 2. Basis, 3. Description, 4. Results and statement, 5. Notes in parenthesis

Expert Statement
No. 19-00181-GR01-01-04-04-01

Statement of Expert Statement No. 19-00181-GR01-01-04-04-01 dated 20 September 2019

Date of Expert Statement: 20 September 2019

Client: **Aksoy Akıncı Yapı Elemanları**
Aksoy İnşaat Sanayi Yatırımları
Manisa / Turkey

Order: Expert statement on the sound insulation of a window unit

Object: Single window unit composed of wood profiles

Contents: 1. Client, 2. Basis, 3. Description, 4. Results and statement, 5. Notes in parenthesis

Evidence of Performance
Advanced sound insulation of building elements

Test report No. 19-00181-PR01 (P2-01-01-01-01)

Client: **Aksoy Akıncı Yapı Elemanları**
Aksoy İnşaat Sanayi Yatırımları
Manisa / Turkey

Product: Single leaf single window

Window type: **W1**

Dimensions: 1,200 mm x 1,400 mm

Weight: 18 and 19 kg

Installation: 1. Central seal, 2. Internal seal

Measuring point: B, C and G

Measuring method: B, C and G

Measuring conditions: 1. 20°C, 2. 50% RH, 3. 0.5 m/s wind speed, 4. 0.5 m/s wind direction

Weighted sound reduction index R_w
Sound reduction index C and G

$R_w(C) C_{tr} = 41 (-2;-4) dB$

Signature: J. Kemper, P. Nuss

Evidence of Performance
Advanced sound insulation of building elements

Test report No. 19-00181-PR01 (P2-01-01-01-01)

Client: **Aksoy Akıncı Yapı Elemanları**
Aksoy İnşaat Sanayi Yatırımları
Manisa / Turkey

Product: Single leaf single window

Window type: **W1**

Dimensions: 1,200 mm x 1,400 mm

Weight: 18 and 19 kg

Installation: 1. Central seal, 2. Internal seal

Measuring point: B, C and G

Measuring method: B, C and G

Measuring conditions: 1. 20°C, 2. 50% RH, 3. 0.5 m/s wind speed, 4. 0.5 m/s wind direction

Weighted sound reduction index R_w
Sound reduction index C and G

$R_w(C) C_{tr} = 42 (-1;-3) dB$

Signature: J. Kemper, P. Nuss

UAP

WCS
WORLD CERTIFICATION SERVICES

CERTIFICATE OF REGISTRATION

ISO 9001:2008

SELEKTION ELEKTROKİMYA SANAYİ VE TİCARET LİMİTED ŞİRKETİ
AKSOY İNŞAAT SANAYİ YATIRIMLARI
MANİSA / TÜRKİYE

SELEKTION ELEKTROKİMYA SANAYİ VE TİCARET LİMİTED ŞİRKETİ
AKSOY İNŞAAT SANAYİ YATIRIMLARI
MANİSA / TÜRKİYE

SELEKTION ELEKTROKİMYA SANAYİ VE TİCARET LİMİTED ŞİRKETİ
AKSOY İNŞAAT SANAYİ YATIRIMLARI
MANİSA / TÜRKİYE

SELEKTION ELEKTROKİMYA SANAYİ VE TİCARET LİMİTED ŞİRKETİ
AKSOY İNŞAAT SANAYİ YATIRIMLARI
MANİSA / TÜRKİYE

Evidence of Performance
Advanced sound insulation of building elements

Test report No. 19-00181-PR01 (P2-01-01-01-01)

Client: **Aksoy Akıncı Yapı Elemanları**
Aksoy İnşaat Sanayi Yatırımları
Manisa / Turkey

Product: Single leaf single window

Window type: **W1**

Dimensions: 1,200 mm x 1,400 mm

Weight: 18 and 19 kg

Installation: 1. Central seal, 2. Internal seal

Measuring point: B, C and G

Measuring method: B, C and G

Measuring conditions: 1. 20°C, 2. 50% RH, 3. 0.5 m/s wind speed, 4. 0.5 m/s wind direction

Weighted sound reduction index R_w
Sound reduction index C and G

$R_w(C) C_{tr} = 29 (-2;-6) dB$

Signature: J. Kemper, P. Nuss

DECLARATION OF CONFORMITY
FOLLOWING THE EUROPEAN DIRECTIVE
ON THE
CONSTRUCTION PRODUCTS

Manufacturer's name: **Selektion Elektro-Kimya Sanayi ve Ticaret Ltd. St.**

Manufacturer's address: **Atasok Akıncı Sanayi Yatırımları, Manisa / Turkey**

Product description: **WOODEN WINDOWS**

Technical description: **WOODEN WINDOWS**

European standard: **EN 14353-1:2008**

Technical body address: **ARBOR**

Signature: **ARBOR**

FIRST QUALITY CERTIFICATION

FOC
FIRST QUALITY CERTIFICATION

SERTİFİKA

SELEKTION ELEKTROKİMYA SANAYİ VE TİCARET LİMİTED ŞİRKETİ

SELEKTION ELEKTROKİMYA SANAYİ VE TİCARET LİMİTED ŞİRKETİ
AKSOY İNŞAAT SANAYİ YATIRIMLARI
MANİSA / TÜRKİYE

SELEKTION ELEKTROKİMYA SANAYİ VE TİCARET LİMİTED ŞİRKETİ
AKSOY İNŞAAT SANAYİ YATIRIMLARI
MANİSA / TÜRKİYE

SELEKTION ELEKTROKİMYA SANAYİ VE TİCARET LİMİTED ŞİRKETİ
AKSOY İNŞAAT SANAYİ YATIRIMLARI
MANİSA / TÜRKİYE

SELEKTION ELEKTROKİMYA SANAYİ VE TİCARET LİMİTED ŞİRKETİ
AKSOY İNŞAAT SANAYİ YATIRIMLARI
MANİSA / TÜRKİYE

Nachweis
Werkstoffprüfungsausschnitt
Prüfnummer 19.080291.01.P001.001.00.00.01

Arbeits Auftrag Tag: Element
Arbeitsauftrag: Arbeit für ein Element aus Holz 2/4
Arbeitsnummer:
Arbeitsdatum:

Ergebnisse:
Ergebnis: $C_{90} = 1,3 \text{ W/m}^2 \cdot \text{K}$

Prüfung:
Prüfung: C_{90}
Prüfungstermin: 19.08.2019

Prüfungsort:
Prüfungsort: 19.08.2019

Prüfungsergebnisse:
Prüfungsergebnisse: $C_{90} = 1,3 \text{ W/m}^2 \cdot \text{K}$

Gefährliche Stellungnahme
19.08.2019 01.01.001.001.00.00.01
19.08.2019

Arbeits Auftrag Tag: Element
Arbeitsauftrag: Arbeit für ein Element aus Holz 2/4
Arbeitsnummer:
Arbeitsdatum:

Ergebnisse:
Ergebnis: $C_{90} = 1,3 \text{ W/m}^2 \cdot \text{K}$

Prüfung:
Prüfung: C_{90}
Prüfungstermin: 19.08.2019

Prüfungsort:
Prüfungsort: 19.08.2019

Prüfungsergebnisse:
Prüfungsergebnisse: $C_{90} = 1,3 \text{ W/m}^2 \cdot \text{K}$

E.F. Forschung & Entwicklungsgesellschaft Leuze und Partner mbH
Forschung 25, 30112 Hagenberg, Telefon 07071 97000, Telefax 07071 970010

Prüfzeugnis

Das Produkt: Alder Holzwerkstoff
Die Firma: Resona Bauwerk GmbH
Resona Bauwerkstraße 13
39621 Lützenau

Prüfungstermin: 15.11.2019

Prüfungsort: Hagenberg, 15.11.2019

E.F. Forschung & Entwicklungsgesellschaft Leuze und Partner mbH
Dr. Ingrid Resona
Vizepräsidentin

VITRAGE ISOLANT

CEKAL
VITRAGE ISOLANT

CERTIFICAT DE PRODUITS

PRODUIT CERTIFIÉ

Prüfungstermin: 15.11.2019

Prüfungsort: Hagenberg, 15.11.2019

EC Declaration of Conformity

CONSTRUCTION PRODUCTS SUBJECTIVE CERTIFICATION

Hersteller: Star Group Holdings, Cem System Distributor, Inc. via T.A.S.
Adresse: Akatlar Sanayi Bölgesi Four Months Bank cad. No: 19
34080 Hedefler / Istanbul / Turkey

Produkt/Description: Insulating Double Glass Unit
Operating Environment: Normal Conditions, Home, Office, Workshop and Store

Prüfungstermin: 15.11.2019

Prüfungsort: Hagenberg, 15.11.2019

TÜRK STANDARLARI ENSTİTÜSÜ
TÜRK STANDARLARINA UYUMLUK BELGESİ
TURKISH STANDARDS INSTITUTION
CERTIFICATE OF CONFORMITY TO TURKISH STANDARDS

Ürün Tanımı: Isı Yalıtımlı Cam Birlikleri

Prüfungstermin: 15.11.2019

Prüfungsort: Hagenberg, 15.11.2019

TÜRK STANDARLARI ENSTİTÜSÜ
TÜRK STANDARLARINA UYUMLUK BELGESİ
TURKISH STANDARDS INSTITUTION
CERTIFICATE OF CONFORMITY TO TURKISH STANDARDS

Ürün Tanımı: Isı Yalıtımlı Cam Birlikleri

Prüfungstermin: 15.11.2019

Prüfungsort: Hagenberg, 15.11.2019

TÜRK STANDARLARI ENSTİTÜSÜ
TÜRK STANDARLARINA UYUMLUK BELGESİ
TURKISH STANDARDS INSTITUTION
CERTIFICATE OF CONFORMITY TO TURKISH STANDARDS

Ürün Tanımı: Isı Yalıtımlı Cam Birlikleri

Prüfungstermin: 15.11.2019

Prüfungsort: Hagenberg, 15.11.2019

45

SGS

Chain-of-Custody

For the products detailed in the scope below

FSC

SGS

LGAM InterCert

Certificate of verification of the PEFC "Chain of Custody"

Holz Schiller

PEFC

InterCert

HESITATIONS ABOUT WOOD

PROBLEM

Deformation:

Solid wood changing its shape due to changes on humidity and temperature.

Ordinary wood section



PROBLEM

Rotting:

Massive wood, in its natural form, is the main food of some bacteria, fungi and insects. Old fashioned paints, which form nonpermeable films, prevent breathing of wood but not rotting.

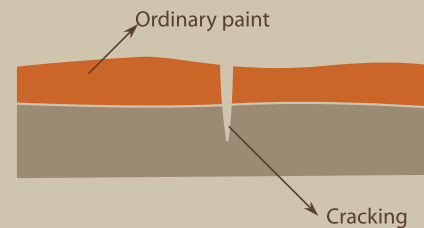

SOLUTION

Lamination Technique:

Three properly selected layers of solid wood are adhered in opposite working directions. Thus, twisting tendencies of each plate "reset" each other.

Fenex Wood Section

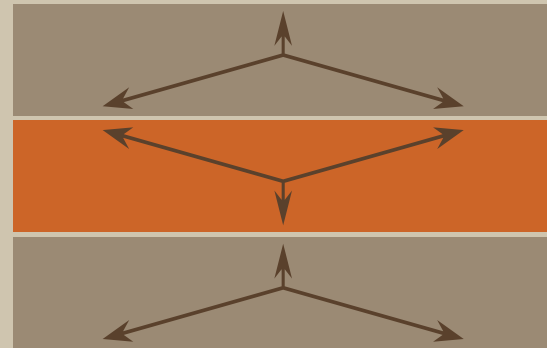

SOLUTION

Flexible Paint:

The surfaces of Fenex products are coated with a flexible paint. This special paint which does not prevent wood of breathing (emitting and inhaling humidity) responds to surfacial cracks on wood by stretching and therefore does not crack. Since extreme humidity and bacteria etc attack wood through cracks, this property is an important guard against rotting.

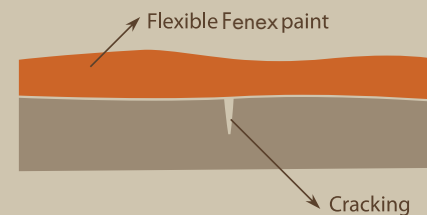





FENEX
WOOD WINDOWS



FENEX Windows Ltd
26 St Cross Street, Clerkenwell,
London EC1N 8UH ENGLAND
T: +44 (0) 208 0756684
www.fenexwindows.co.uk

SELECTRON Ltd. Şti.
Atatürk Bulvarı, Köstemir Yolu Cad. No: 74
Silivri 34570 İstanbul / TÜRKİYE
T: +90 212 7360801
www.arbor.com.tr

ARBOR SAS
16 Rue Séjourné 94000
Créteil / FRANCE
T: +33 (0) 1 43 77 56 36
www.fenetreenbois.fr

ARBOR Fenster und Türen GmbH
Am langen Graben 31
D-52353 Düren DEUTSCHLAND
T: 02421 - 83022
www.holzfenstertueren.de

